

SITE 4 - LAND SOUTH OF HEMPSTED

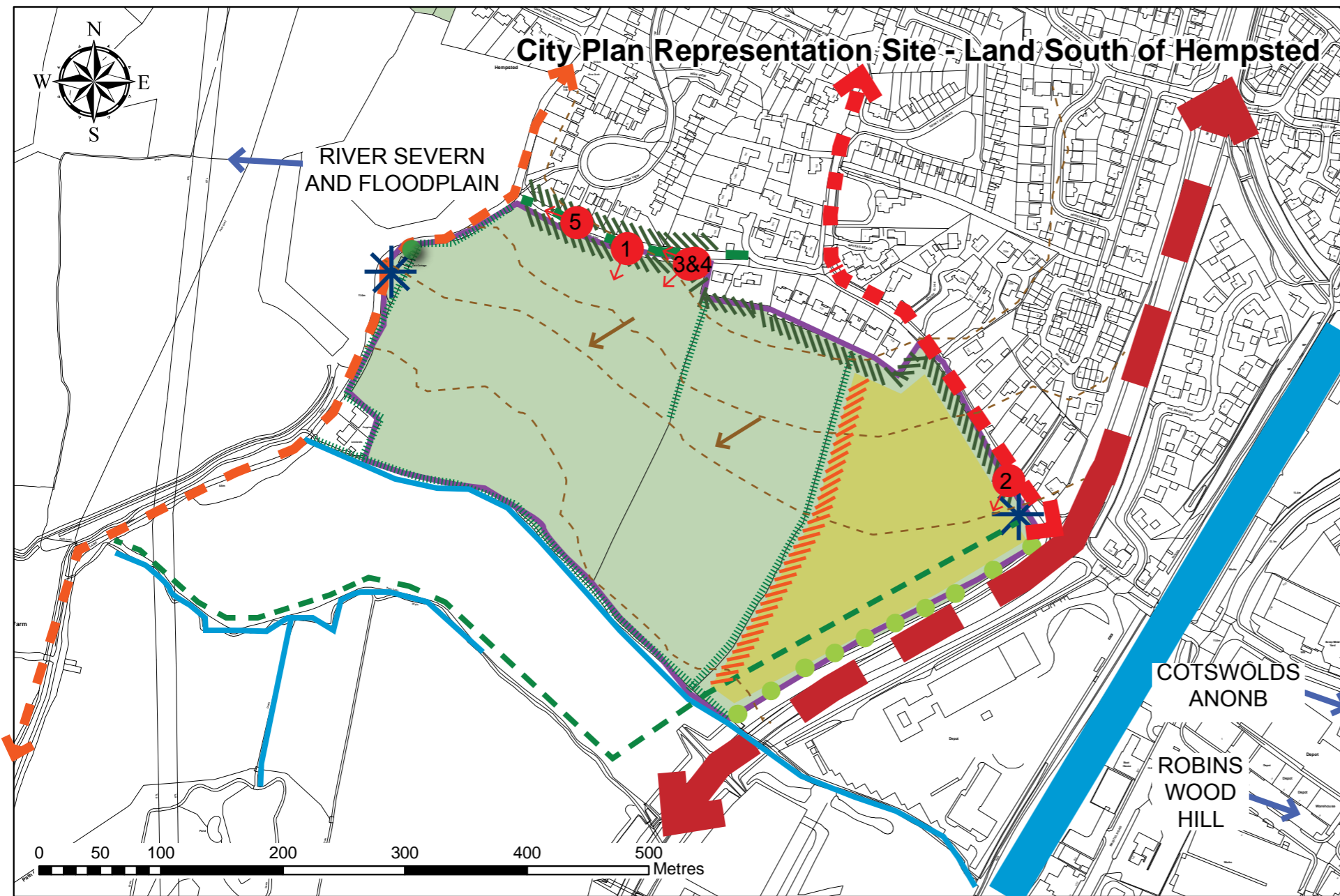

- KEY**
- Site boundary
 - Major road
 - Intermediate road
 - Minor road
 - Existing Landscape buffer - strategic screening
 - Proposed landscape buffer - strategic screening
 - Tree avenue
 - Significant trees
 - Access
 - Public Right of Way Bridleway
 - Public Right of Way footpath
 - Topography/ sloping downwards
 - Existing Hedgerow
 - Views across Site
 - Photograph location
 - Watercourses
 - Potential Area for Development
 - Area not suitable for Development



Photograph 2: Looking south towards Site. Currently used as arable farming land, industrial units to the south partially visible and lighting and tree planting along the A430. Lower topography and crops restrict views.



Photograph 3: Along Public Right of Way looking south-west towards Site. Higher topography along ridge line allows views across site and surrounding hills, countryside and residential buildings along Rea Lane.



Photograph 4: View along northern Site boundary looking west. Landscape buffer on either side of Public Right of Way allows intermittent glimpse views to Site.



Photograph 5: View along northern Site boundary looking west. Second story views from rear winders of adjacent residential properties.

This map is reproduced from Ordnance Survey material with the permission of Ordnance Survey on behalf of the Controller of Her Majesty's Stationery Office © Crown copyright. Unauthorized reproduction infringes Crown copyright and may lead to prosecution or civil proceedings. Licence no 100019169. 2013.



Photograph 1: Looking south-east to south-west across the Site. Panoramic views to the A430 and industrial development to the south-east, landscape screening and glimpse views to the sewerage works (south), Wooded hills of Hockley Hill and Windmill Hill, River Severn and fields and hedgerows to the south-west.