

Buckenham Walk Play Area

Gloucester City Council

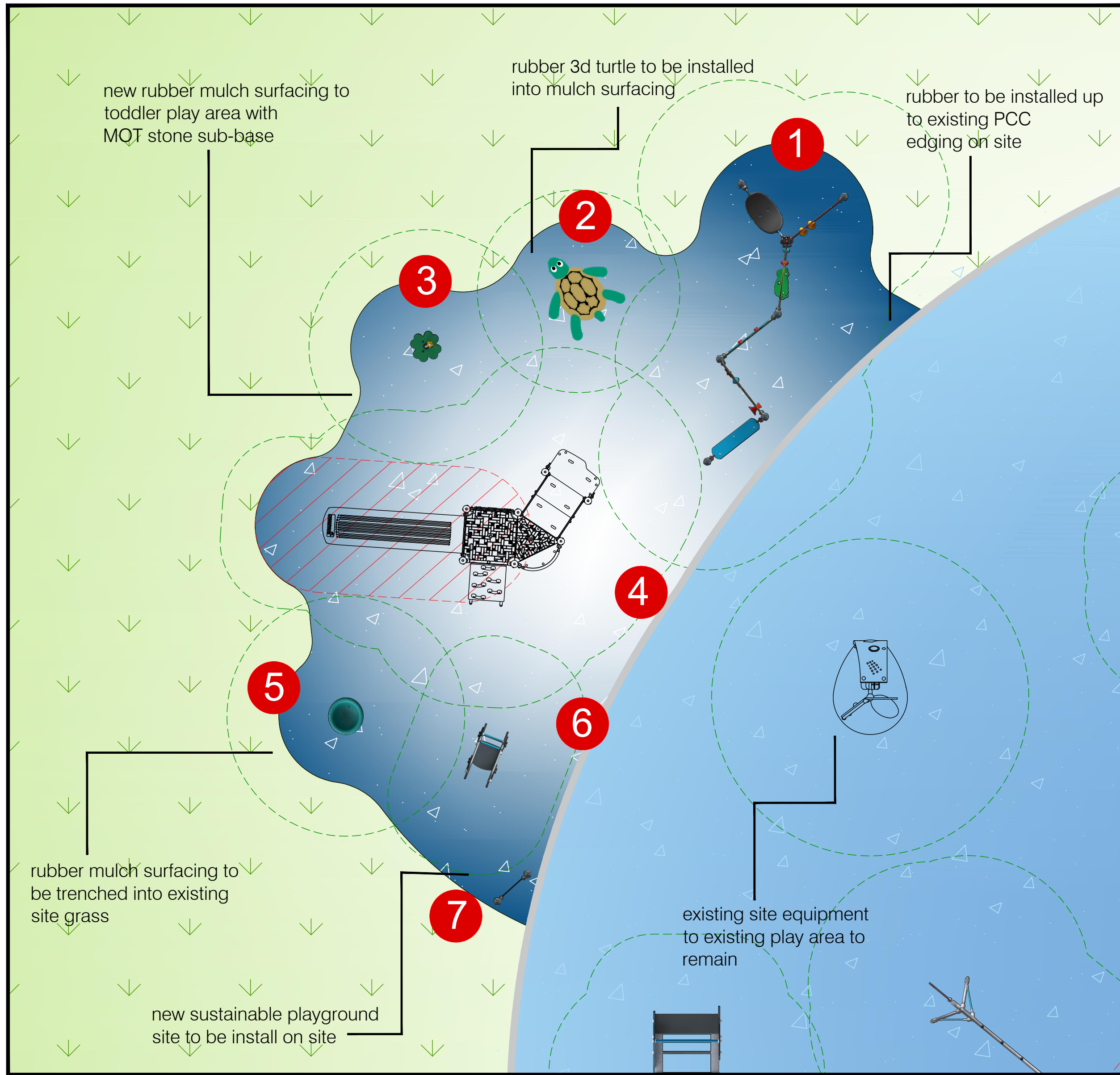

Equipment

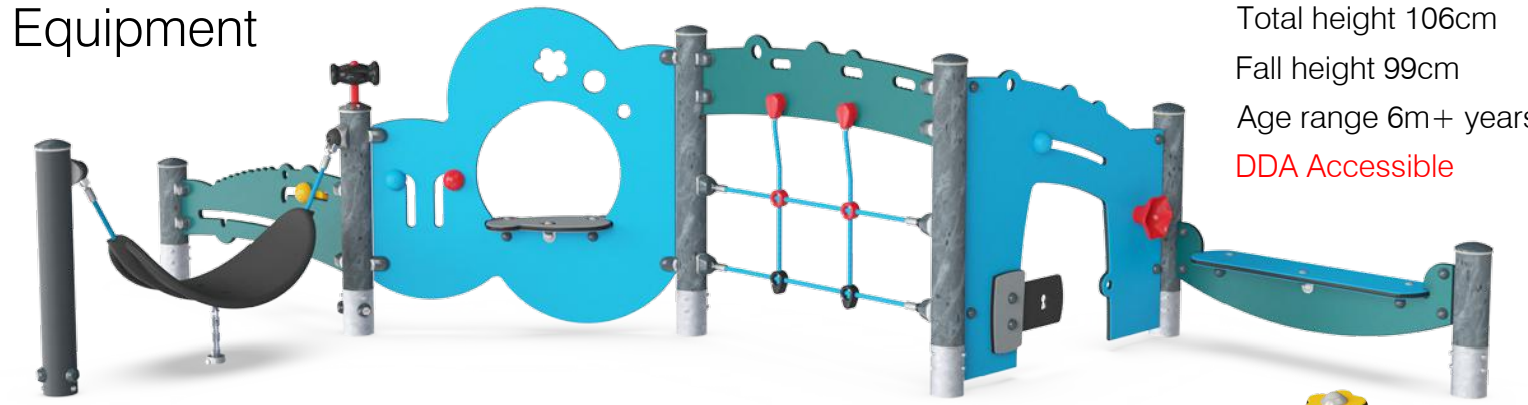

1. **Talk & Tumble**
 Ref PCM000421
 Total height 106cm
 Fall height 99cm
 Age range 6m+ years
 DDA Accessible



2. **3d Turtle**
 Ref SUR18390-301
 Total height 60cm
 Fall height 100cm
 Age range 6m+ years
 DDA Accessible

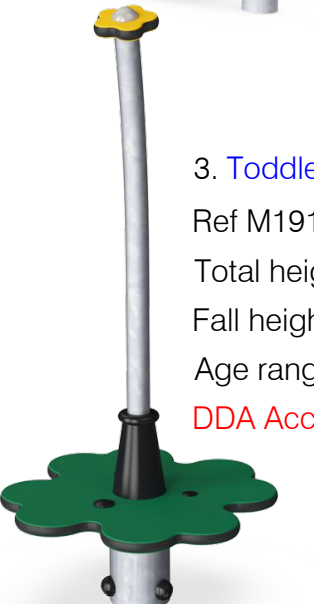

3. **Toddler Spica**
 Ref M191
 Total height 97cm
 Fall height 60cm
 Age range 1+ years
 DDA Accessible



4. **Play Tower w/ ADA stairs & plastic slide**
 Ref PCM101621-20151373
 Total height 200cm
 Fall height 118cm
 Age range 2+ years
 DDA Accessible



5. **Spinner Bowl**
 Ref ELE400024
 Total height 60cm
 Fall height 100cm
 Age range 4+ years
 DDA Accessible



6. **Dune Buggy Springer**
 Ref M170
 Total height 77cm
 Fall height 60cm
 Age range 1+ years
 DDA Accessible



7. **Custom Playground Sign**
 Ref PCM203 - 20151413
 Total height 150cm
 Fall height 0cm
 Age range 0+ years
 DDA Accessible

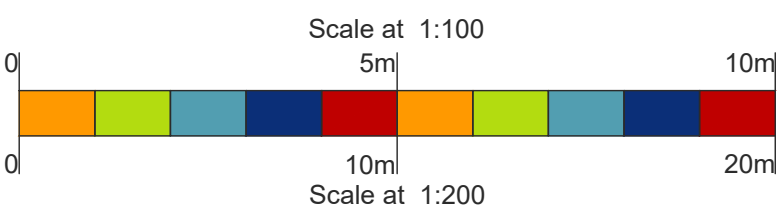

SURFACES	
Existing Grass	EPDM Wetpour Black Safety Surface
Rubber Mulch Blue Safety Surface	PCC Edging Existing PCC edging on site

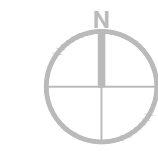

Design assumes the site will be levelled by other (max. gradient 1:100), free draining and with good access

Quotation and design is submitted site unseen, we reserve the right, following a full site survey to amend the design appropriately.

Areas and dimensions shown are critical for compliance with European safety standards En1176 & En1177, If in doubt ask.

Grass areas should be well established prior to grass mat safety surfacing being laid.

KOMPAN Ltd.
 Serenity House
 Milton Keynes
 MK4 1GA

www.KOMPAN.co.uk
 T:01908 201002
 F:01908 201007
 E:KOMPAN.UK@KOMPAN.com

NOT FOR TENDER ISSUE.
 ©copyright of this drawing remains the property of KOMPAN Ltd. and the KOMPAN group. This drawing may not be reproduced without prior permission of KOMPAN Ltd.
 Any infringement will be pursued.

Project BUCKENHAM_WALK_PLAY_AREA	Designed by KC
Client GLOUCESTER_CITY_COUNCIL	Date 15/02/2022
Drawing No. CAS-146448-P7Z4Y9	Scale 1:50@A2
	Revision -