

## Application for Consent to Display an Advertisement(s)

Town and Country Planning (Control of Advertisement) (England) Regulations 2007 (as amended)

### Publication of applications on planning authority websites

Please note that the information provided on this application form and in supporting documents may be published on the Authority's website. If you require any further clarification, please contact the Authority's planning department.

### Site Location

**Disclaimer:** We can only make recommendations based on the answers given in the questions.

If you cannot provide a postcode, the description of site location must be completed. Please provide the most accurate site description you can, to help locate the site - for example "field to the North of the Post Office".

Number

Suffix

Property Name

Address Line 1

Address Line 2

Address Line 3

Town/city

Postcode

Description of site location must be completed if postcode is not known:

Easting (x)  Northing (y)

Description

## Applicant Details

### Name/Company

Title

Mr

First name

Andy

Surname

Horwood

Company Name

Tesco

### Address

Address line 1

Kestrel Way

Address line 2

Address line 3

Town/City

Welwyn Garden City

Country

United Kingdom

Postcode

AL7 1GB

Are you an agent acting on behalf of the applicant?

Yes

No

### Contact Details

Primary number

\*\*\*\*\* REDACTED \*\*\*\*\*

Secondary number

Fax number

Email address

### Type of Proposed Advertisement(s)

Please describe the proposed advertisement(s)

**Advertisement Type:**

Fascia Sign

**Height:**

0.68 metres

**Width:**

2.89 metres

**Depth:**

0.125 metres

**What is the height from the ground to the base of the advertisement?:**

2.73 metres

**What is the maximum projection of the advertisement from the face of the building?:**

0.125 metres

**What is the maximum height of any of the individual letters and symbols?:**

32 centimetres

**What materials will the advertisement be made of?:**

2mm formed aluminium, powder coated white RAL 9010. Internal illumination to letters only. Tesco in Opal 030 Avery 4509 Red 431, And Express & blips in Opal 030- Avery 5600 LD/082A blue, translucent acrylic letters applied to face.

**The colour of text and background:**

As shown in"2925\_ProposedElevation"-sign-1

**Will the advertisement be illuminated?:**

Yes

**Will the advertisement be illuminated internally or externally?:**

Internally

**Illuminance levels:**

350 cd/m<sup>2</sup>

**Will the illumination be static or intermittent?:**

Static

**Advertisement Type:**

Fascia Sign

**Height:**

0.68 metres

**Width:**

5.24 metres

**Depth:**

0.125 metres

**What is the height from the ground to the base of the advertisement?:**

2.73 metres

**What is the maximum projection of the advertisement from the face of the building?:**

0.125 metres

**What is the maximum height of any of the individual letters and symbols?:**

10 centimetres

**What materials will the advertisement be made of?:**

2mm formed aluminium, powder coated Blue RAL 5005, 30% Gloss with Brown Arizona Oak woodtex strip to base. Store Address and Est. year vinyl lettering applied to new fascia, non illuminated.

**The colour of text and background:**

As shown in"2925\_ProposedElevation"-sign-2

**Will the advertisement be illuminated?:**

**Advertisement Type:**

Projecting or Hanging Sign

**Height:**

0.65 metres

**Width:**

0.8 metres

**Depth:**

0.125 metres

**What is the height from the ground to the base of the advertisement?:**

2.77 metres

**What is the maximum projection of the advertisement from the face of the building?:**

0.8 metres

**What is the maximum height of any of the individual letters and symbols?:**

20 centimetres

**What materials will the advertisement be made of?:**

2mm formed aluminium, Powder coated white RAL 9010. Internal illumination to Acrylic letters only. Tesco in Opal 030 Avery 4509 Red 431, and Express & blips in Opal 030-Avery 5600 LD/082A blue, translucent acrylic letters applied to face. Sides, top and bottom to be blue as per fascia.

**The colour of text and background:**

As shown in "2925\_ProposedElevation"-sign-3

**Will the advertisement be illuminated?:**

Yes

**Will the advertisement be illuminated internally or externally?:**

Internally

**Illuminance levels:**

350 cd/m<sup>2</sup>

**Will the illumination be static or intermittent?:**

Static

**Advertisement Type:**

Projecting or Hanging Sign

**Height:**

0.65 metres

**Width:**

0.8 metres

**Depth:**

0.125 metres

**What is the height from the ground to the base of the advertisement?:**

2.77 metres

**What is the maximum projection of the advertisement from the face of the building?:**

0.8 metres

**What is the maximum height of any of the individual letters and symbols?:**

20 centimetres

**What materials will the advertisement be made of?:**

2mm formed aluminium, Powder coated white RAL 9010. Internal illumination to Acrylic letters only. Tesco in Opal 030 Avery 4509 Red 431, and Express & blips in Opal 030-Avery 5600 LD/082A blue, translucent acrylic letters applied to face. Sides, top and bottom to be blue as per fascia.

**The colour of text and background:**

As shown in "2925\_ProposedElevation"-sign-4

**Will the advertisement be illuminated?:**

Yes

**Will the advertisement be illuminated internally or externally?:**

Internally

**Illuminance levels:**

350 cd/m<sup>2</sup>

**Will the illumination be static or intermittent?:**

Static

**Advertisement Type:**

Other type

**Height:**

1.7 metres

**Width:**

0.8 metres

**Depth:**

0.01 metres

**What is the height from the ground to the base of the advertisement?:**

0.38 metres

**What is the maximum projection of the advertisement from the face of the building?:**

0 metres

**What is the maximum height of any of the individual letters and symbols?:**

20 centimetres

**What materials will the advertisement be made of?:**

3mm vinyl

**The colour of text and background:**

As shown in "2925\_ProposedElevation"-sign-5

**Will the advertisement be illuminated?:**

**Advertisement Type:**

Other type

**Height:**

1.98 metres

**Width:**

2.05 metres

**Depth:**

0.01 metres

**What is the height from the ground to the base of the advertisement?:**

0.71 metres

**What is the maximum projection of the advertisement from the face of the building?:**

0 metres

**What is the maximum height of any of the individual letters and symbols?:**

20 centimetres

**What materials will the advertisement be made of?:**

3mm vinyl

**The colour of text and background:**

As shown in "2925\_ProposedElevation"-sign-6

**Will the advertisement be illuminated?:**

**Advertisement Type:**

Other type

**Height:**

1.98 metres

**Width:**

2.05 metres

**Depth:**

0.01 metres

**What is the height from the ground to the base of the advertisement?:**

0.71 metres

**What is the maximum projection of the advertisement from the face of the building?:**

0 metres

**What is the maximum height of any of the individual letters and symbols?:**

20 centimetres

**What materials will the advertisement be made of?:**

3mm vinyl

**The colour of text and background:**

As shown in"2925\_ProposedElevation"-sign-7

**Will the advertisement be illuminated?:**

**Advertisement Type:**

Other type

**Height:**

1.98 metres

**Width:**

1 metres

**Depth:**

0.01 metres

**What is the height from the ground to the base of the advertisement?:**

0.71 metres

**What is the maximum projection of the advertisement from the face of the building?:**

0 metres

**What is the maximum height of any of the individual letters and symbols?:**

20 centimetres

**What materials will the advertisement be made of?:**

3mm vinyl

**The colour of text and background:**

As shown in"2925\_ProposedElevation"-sign-8

**Will the advertisement be illuminated?:**

Please describe each of the 'Other type(s)' of advertising proposed

4x vinyls

## Location of Advertisement(s)

Is the advertisement(s) you are applying for already in place?

Yes

No

Is an existing advertisement(s) to be removed and replaced by the advertisement(s) in this proposal?

Yes

No

Not Applicable

If Yes to either or both above, please show the existing sign(s) on an elevation drawing or photograph and state the references for the drawing(s) or photograph(s)

2925\_ProposedElevation

2925\_ExistingElevation

Will the proposed advertisement(s) project over a footpath or other public highway?

- Yes  
 No

## Advertisement(s) Period

Please state the period of time for which consent is sought for the advertisement

From Date

19/06/2022

To Date

19/06/2027

## Neighbour and Community Consultation

Have you consulted your neighbours or the local community about the proposal?

- Yes  
 No

## Site Visit

Can the site be seen from a public road, public footpath, bridleway or other public land?

- Yes  
 No

If the planning authority needs to make an appointment to carry out a site visit, whom should they contact?

- The agent  
 The applicant  
 Other person

## Pre-application Advice

Has assistance or prior advice been sought from the local authority about this application?

- Yes  
 No

## Interest In the Land

Does the applicant own the land or buildings where the adverts are to be placed?

- Yes  
 No

If No, has the permission of the owner or any other person entitled to give permission for the display of an advertisement been obtained?

- Yes  
 No



## Authority Employee/Member

With respect to the Authority, is the applicant and/or agent one of the following:

- (a) a member of staff
- (b) an elected member
- (c) related to a member of staff
- (d) related to an elected member

It is an important principle of decision-making that the process is open and transparent.

For the purposes of this question, "related to" means related, by birth or otherwise, closely enough that a fair-minded and informed observer, having considered the facts, would conclude that there was bias on the part of the decision-maker in the Local Planning Authority.

Do any of the above statements apply?

- Yes
- No

## Declaration

I / We hereby apply for Consent to display an advertisement as described in this form and accompanying plans/drawings and additional information. I / We confirm that, to the best of my/our knowledge, any facts stated are true and accurate and any opinions given are the genuine opinions of the persons giving them. I / We also accept that: Once submitted, this information will be transmitted to the Local Planning Authority and, once validated by them, be made available as part of a public register and on the authority's website; our system will automatically generate and send you emails in regard to the submission of this application.

I / We agree to the outlined declaration

Signed

Andy Horwood

Date

22/06/2022

SITE LOCATION PLAN  
AREA 4 HA  
SCALE: 1:1250 on A4  
CENTRE COORDINATES: 385617 , 219584



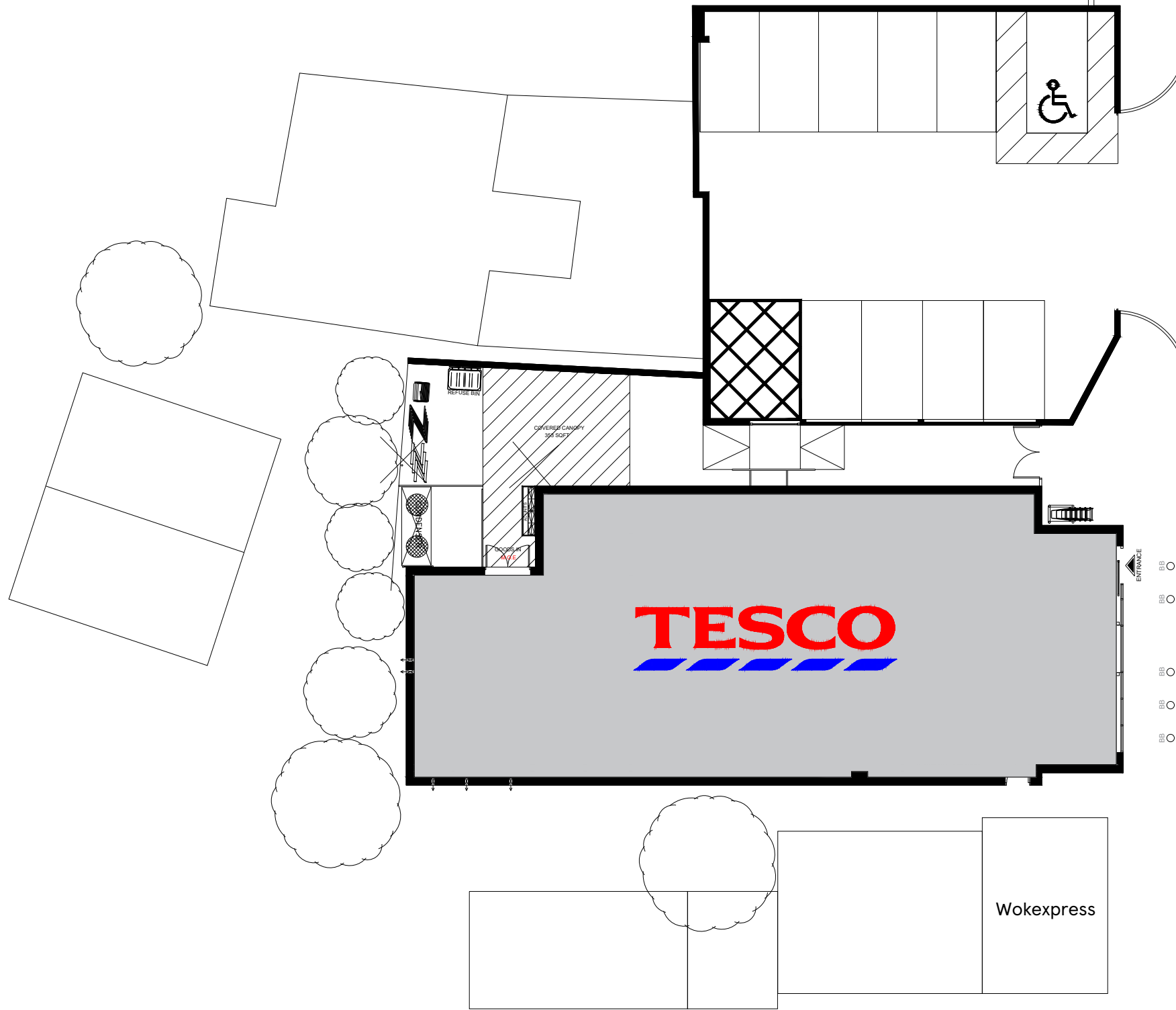

OLD CHELTENHAM ROAD

SCALE BAR

1:200

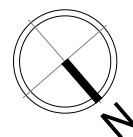
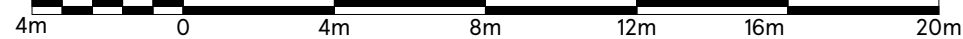

DRAWING NO  
02\_2925\_02A

SCALE  
1:200@A3

CHECKED BY  
SHIKHA  
DRAWN BY  
GAGANA

DATE  
08.06.2022

STORE TYPE  
EXPRESS

STORE NAME  
LONGLEVENS

CONTENT  
EXISTING SITE PLAN\_ADV

**TESCO**  
 FEASIBILITY PLANNING  
 STORE PLANNING DEPARTMENT  
 PROPERTY SERVICES  
 HIGHWOODS BUILDING, KESTREAL WAY  
 WELWYN GARDEN CITY, HERTFORDSHIRE, AL7 1GB UK  
 TELEPHONE : [REDACTED]

THE COPYRIGHT AND ALL OTHER RIGHTS IN AND RELATING TO THIS PUBLICATION BELONG TO AND ARE THE SOLE PROPERTY OF TESCO STORES LIMITED. ALL RIGHTS ARE RESERVED. NEITHER THE WHOLE NOR ANY PART OF THIS PUBLICATION MAY BE REPRODUCED OR TRANSMITTED IN ANY FORM OR BY ANY ELECTRONIC OR MECHANICAL MEANS INCLUDING PHOTOCOPIING AND RECORDING OR FROM ANY RETRIEVAL SYSTEM WITHOUT THE PRIOR WRITTEN LICENCE FROM THE OWNER. ©1997 TESCO STORES LIMITED



OLD CHELTENHAM ROAD

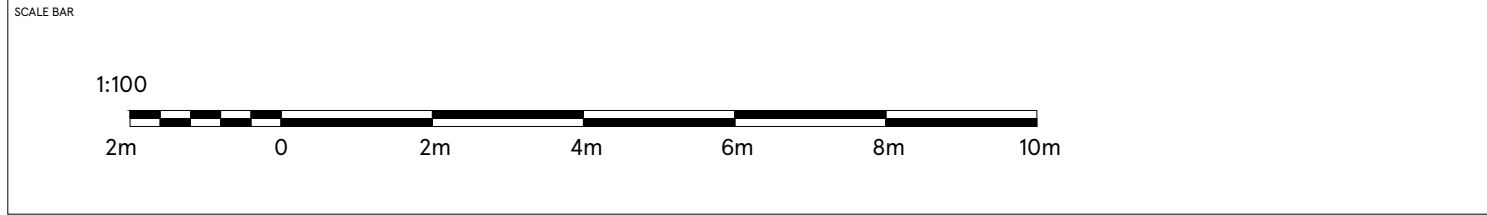

DRAWING NO 02_2925_02B		STORE TYPE EXPRESS
SCALE 1:100@A3	DATE 08.06.2022	STORE NAME LONGLEVENS
CHECKED BY SHIKHA		CONTENT EXISTING PLAN - ADV
DRAWN BY GAGANA		

**TESCO**  
 FEASIBILITY PLANNING  
 STORE PLANNING DEPARTMENT  
 PROPERTY SERVICES  
 HIGHWOODS BUILDING, KESTREAL WAY  
 WELWYN GARDEN CITY, HERTFORDSHIRE, AL7 1GB UK  
 TELEPHONE : [REDACTED]

THE COPYRIGHT AND ALL OTHER RIGHTS IN AND RELATING TO THIS PUBLICATION BELONG TO AND ARE THE SOLE PROPERTY OF TESCO STORES LIMITED. ALL RIGHTS ARE RESERVED. NEITHER THE WHOLE NOR ANY PART OF THIS PUBLICATION MAY BE REPRODUCED OR TRANSMITTED IN ANY FORM OR BY ANY ELECTRONIC OR MECHANICAL MEANS INCLUDING PHOTOCOPIING AND RECORDING OR FROM ANY RETRIEVAL SYSTEM WITHOUT THE PRIOR WRITTEN LICENCE FROM THE OWNER. ©1997 TESCO STORES LIMITED



**WEST ELEVATION**

SCALE BAR

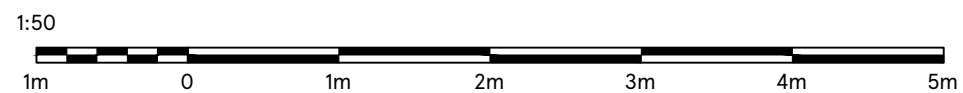

DRAWING NO  
03\_2925\_03A

SCALE  
1:50@A3

CHECKED BY  
SHIKHA  
DRAWN BY  
MATHURAA

DATE  
14.06.2022

STORE TYPE  
EXPRESS

STORE NAME  
LONGLEVENS

CONTENT  
EXISTING ELEVATION

**TESCO**  
FEASIBILITY PLANNING  
STORE PLANNING DEPARTMENT  
PROPERTY SERVICES  
HIGHWOODS BUILDING, KESTREL WAY  
WELWYN GARDEN CITY, HERTFORDSHIRE, AL7 1GB UK  
TELEPHONE : [REDACTED]

THE COPYRIGHT AND ALL OTHER RIGHTS IN AND RELATING TO THIS PUBLICATION BELONG TO AND ARE THE SOLE PROPERTY OF TESCO STORES LIMITED. ALL RIGHTS ARE RESERVED. NEITHER THE WHOLE NOR ANY PART OF THIS PUBLICATION MAY BE REPRODUCED OR TRANSMITTED IN ANY FORM OR BY ANY ELECTRONIC OR MECHANICAL MEANS INCLUDING PHOTOCOPYING AND RECORDING OR FROM ANY RETRIEVAL SYSTEM WITHOUT THE PRIOR WRITTEN LICENCE FROM THE OWNER © 1997 TESCO STORES LIMITED.

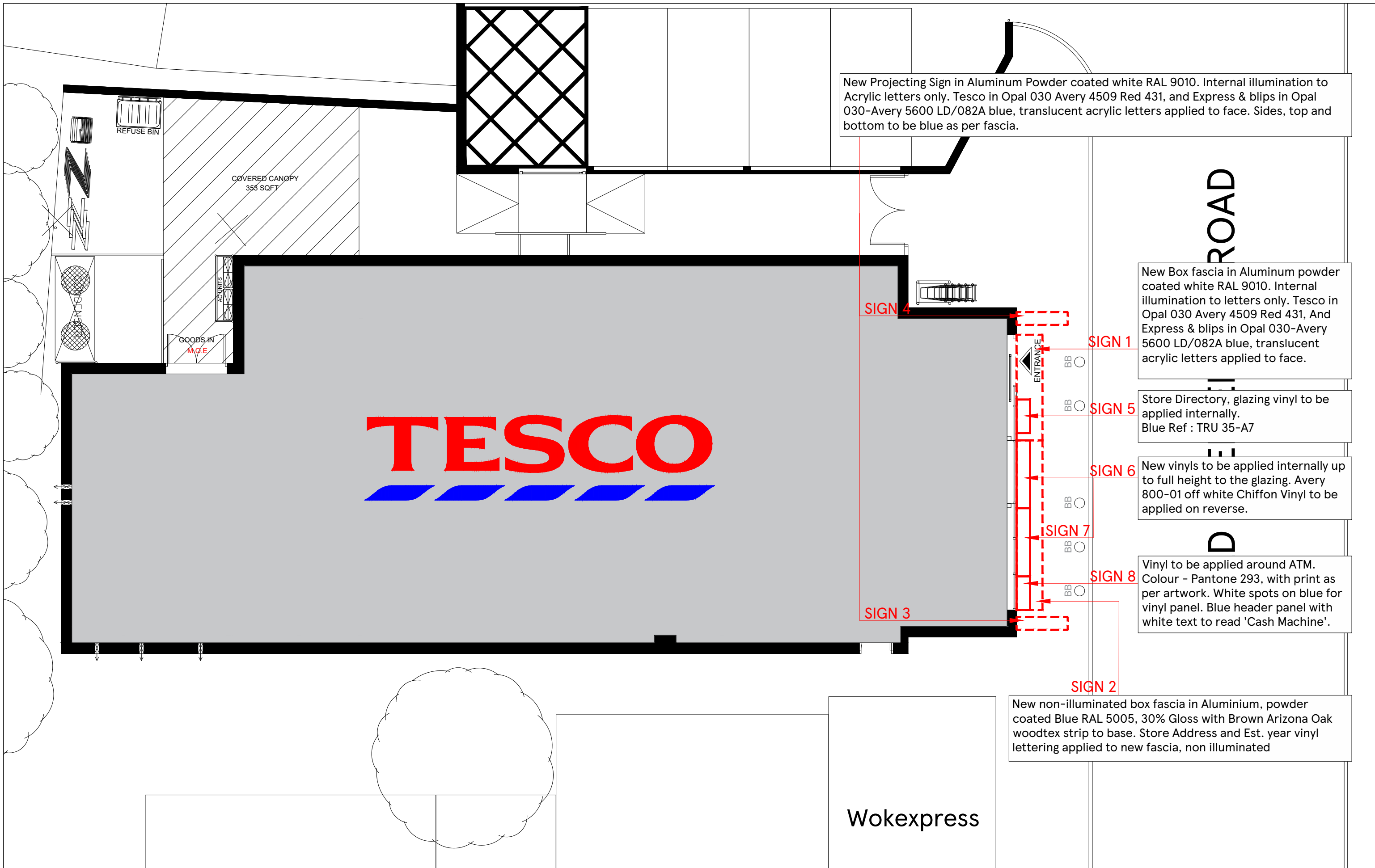

New Projecting Sign in Aluminum Powder coated white RAL 9010. Internal illumination to Acrylic letters only. Tesco in Opal 030 Avery 4509 Red 431, and Express & blips in Opal 030-Avery 5600 LD/082A blue, translucent acrylic letters applied to face. Sides, top and bottom to be blue as per fascia.

New Box fascia in Aluminum powder coated white RAL 9010. Internal illumination to letters only. Tesco in Opal 030 Avery 4509 Red 431, And Express & blips in Opal 030-Avery 5600 LD/082A blue, translucent acrylic letters applied to face.

Store Directory, glazing vinyl to be applied internally. Blue Ref : TRU 35-A7

New vinyls to be applied internally up to full height to the glazing. Avery 800-01 off white Chiffon Vinyl to be applied on reverse.

Vinyl to be applied around ATM. Colour - Pantone 293, with print as per artwork. White spots on blue for vinyl panel. Blue header panel with white text to read 'Cash Machine'.

New non-illuminated box fascia in Aluminium, powder coated Blue RAL 5005, 30% Gloss with Brown Arizona Oak woodtex strip to base. Store Address and Est. year vinyl lettering applied to new fascia, non illuminated

SCALE BAR

1:100

2m 0 2m 4m 6m 8m 10m

DRAWING NO  
02\_2925\_02C

SCALE  
1:100@A3

CHECKED BY  
SHIKHA

DRAWN BY  
GAGANA

STORE TYPE  
EXPRESS

STORE NAME  
LONGLEVENS

CONTENT  
PROPOSED PLAN - ADV

**TESCO**  
FEASIBILITY PLANNING  
STORE PLANNING DEPARTMENT  
PROPERTY SERVICES  
HIGHWOODS BUILDING, KESTREAL WAY  
WELWYN GARDEN CITY, HERTFORDSHIRE, AL7 1GB UK  
TELEPHONE : [REDACTED]

THE COPYRIGHT AND ALL OTHER RIGHTS IN AND RELATING TO THIS PUBLICATION BELONG TO AND ARE THE SOLE PROPERTY OF TESCO STORES LIMITED. ALL RIGHTS ARE RESERVED. NEITHER THE WHOLE NOR ANY PART OF THIS PUBLICATION MAY BE REPRODUCED OR TRANSMITTED IN ANY FORM OR BY ANY ELECTRONIC OR MECHANICAL MEANS INCLUDING PHOTOCOPIING AND RECORDING OR FROM ANY RETRIEVAL SYSTEM WITHOUT THE PRIOR WRITTEN LICENCE FROM THE OWNER. © 1997 TESCO STORES LIMITED



New Projecting Sign in Aluminum Powder coated white RAL 9010. Internal illumination to Acrylic letters only. Tesco in Opal 030 Avery 4509 Red 431, and Express & blips in Opal 030-Avery 5600 LD/082A blue, translucent acrylic letters applied to face. Sides, top and bottom to be blue as per fascia.

**SIGN 3**  
800x650 MM

**SIGN 2**  
5240x680 MM

**SIGN 1**  
2890x680 MM

**SIGN 4**  
800x650 MM

New non-illuminated box fascia in Aluminium powder coated Blue RAL 5005, 30% Gloss with Brown Arizona Oak woodtex strip to base. Store Address and Est. year vinyl lettering applied to new fascia, non illuminated. Store Add/Est. Year-100mm Height

New Box fascia in Aluminium powder coated white RAL 9010. Internal illumination to letters only. Tesco in Opal 030 Avery 4509 Red 431, And Express & blips in Opal 030-Avery 5600 LD/082A blue, translucent acrylic letters applied to face.

New Projecting Sign in Aluminum Powder coated white RAL 9010. Internal illumination to Acrylic letters only. Tesco in Opal 030 Avery 4509 Red 431, and Express & blips in Opal 030-Avery 5600 LD/082A blue, translucent acrylic letters applied to face. Sides, top and bottom to be blue as per fascia.

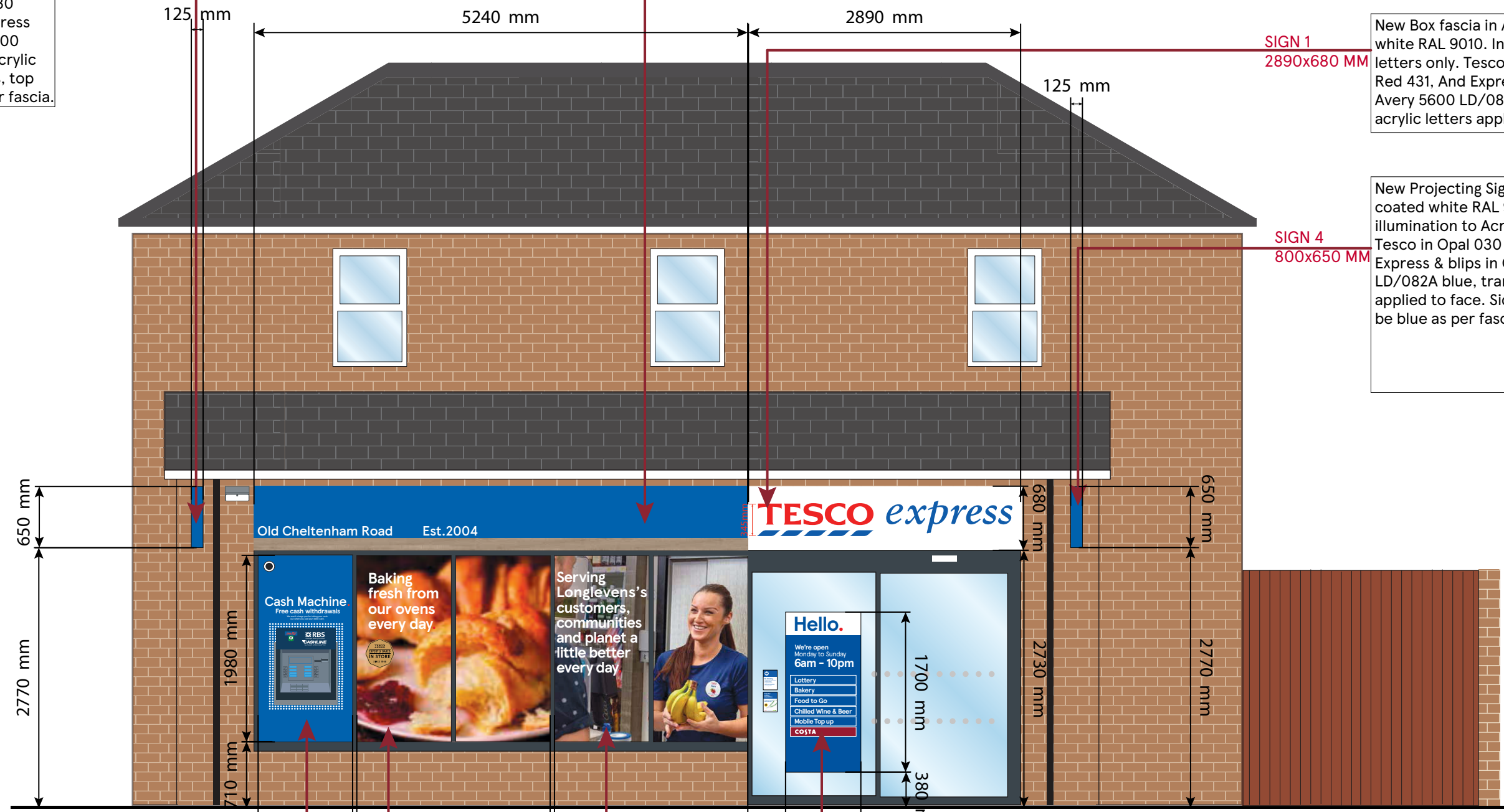

Vinyl to be applied around ATM. Colour - Pantone 293, with print as per artwork. White spots on blue for vinyl panel. Blue header panel with white text to read 'Cash Machine'.

**SIGN 8**  
1000x1980 MM

**SIGN 5**  
800x1700 MM

New vinyls to be applied internally up to full height to the glazing. Avery 800-01 off white Chiffon Vinyl to be applied on reverse.

**SIGN 7**  
2050x1980 MM

**SIGN 6**  
2050x1980 MM

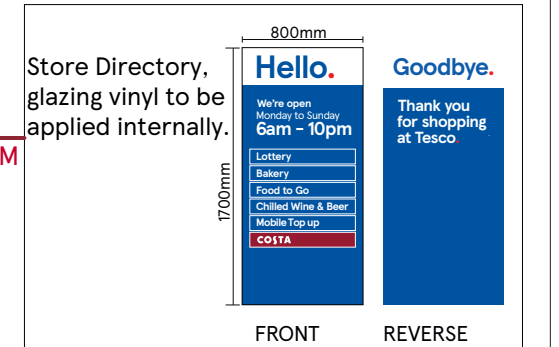

**WEST ELEVATION**

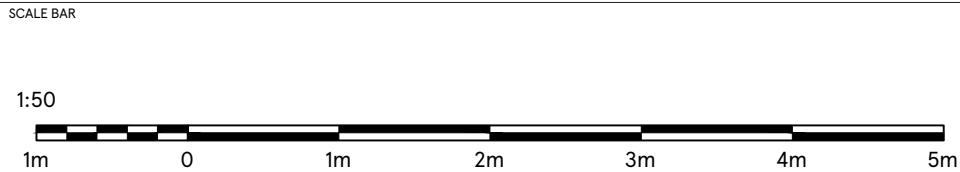

DRAWING NO 03_2925_03B		STORE TYPE EXPRESS
SCALE 1:50@A3	DATE 14.06.2022	STORE NAME LONGLEVENS
CHECKED BY SHIKHA		CONTENT PROPOSED ELEVATION
DRAWN BY MATHURAA		

**TESCO**  
FEASIBILITY PLANNING  
STORE PLANNING DEPARTMENT  
PROPERTY SERVICES  
HIGHWOODS BUILDING, KESTREL WAY  
WELWYN GARDEN CITY, HERTFORDSHIRE, AL7 1GB UK  
TELEPHONE: 0457 700 000

THE COPYRIGHT AND ALL OTHER RIGHTS IN AND RELATING TO THIS PUBLICATION BELONG TO AND ARE THE SOLE PROPERTY OF TESCO STORES LIMITED. ALL RIGHTS ARE RESERVED. WITHOUT THE WHOLE OR ANY PART OF THIS PUBLICATION MAY BE REPRODUCED OR TRANSMITTED IN ANY FORM OR BY ANY ELECTRONIC OR MECHANICAL MEANS INCLUDING PHOTOCOPYING AND RECORDING OR FROM ANY RETRIEVAL SYSTEM WITHOUT THE PRIOR WRITTEN LICENCE FROM THE OWNER © 1997 TESCO STORES LIMITED.

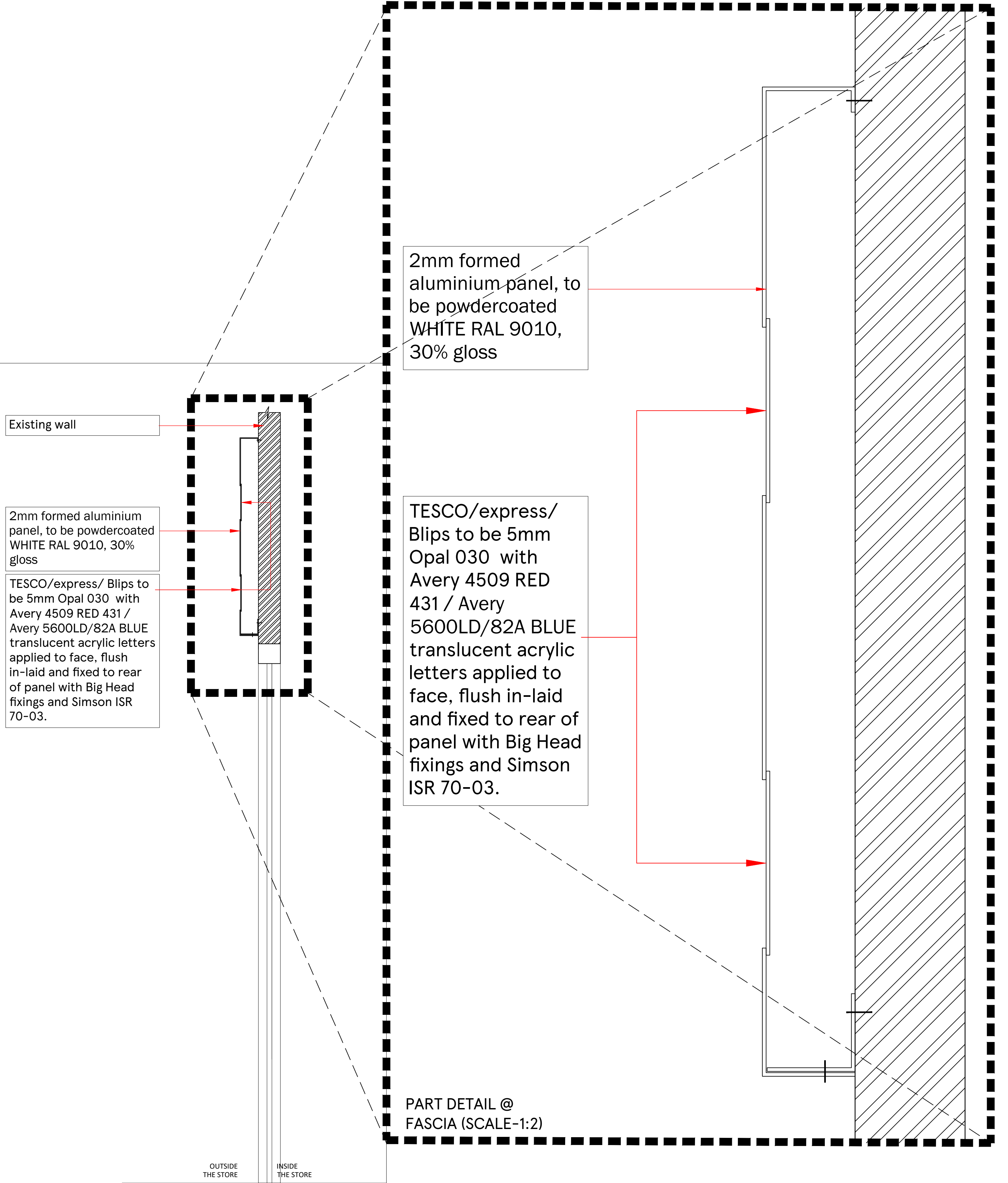

2mm formed aluminium panel, to be powdercoated WHITE RAL 9010, 30% gloss

Existing wall

2mm formed aluminium panel, to be powdercoated WHITE RAL 9010, 30% gloss

TESCO/express/ Blips to be 5mm Opal 030 with Avery 4509 RED 431 / Avery 5600LD/82A BLUE translucent acrylic letters applied to face, flush in-laid and fixed to rear of panel with Big Head fixings and Simson ISR 70-03.

TESCO/express/ Blips to be 5mm Opal 030 with Avery 4509 RED 431 / Avery 5600LD/82A BLUE translucent acrylic letters applied to face, flush in-laid and fixed to rear of panel with Big Head fixings and Simson ISR 70-03.

PART DETAIL @ FASCIA (SCALE-1:2)

OUTSIDE THE STORE      INSIDE THE STORE

SECTION THROUGH STORE ENTRANCE WITH FASCIA (SCALE-1:10)

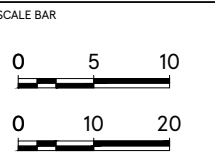

SCALE 1:10/1:2 @A2	DATE 20-JAN-2022	STORE TYPE FASCIA DETAILS
CHECKED BY ANDY HORWOOD		TYPE TYPICAL DETAIL
DRAWN BY SHIKHA		CONTENT BOX FASCIA NON ILLUMINATION DETAIL

**TESCO**  
 FEASIBILITY PLANNING  
 STORE PLANNING DEPARTMENT  
 PROPERTY SERVICES  
 HIGHWOODS BUILDING, KESTREL WAY  
 WELWYN GARDEN CITY, HERTS SG13 7GB UK  
 TELEPHONE: 0457 700000  
THE COPYRIGHT IN THIS DRAWING IS THE PROPERTY OF TESCO STORES LIMITED. ALL RIGHTS ARE RESERVED. NO PART OF THIS PUBLICATION MAY BE REPRODUCED OR TRANSMITTED IN ANY FORM OR BY ANY MEANS, ELECTRONIC OR MECHANICAL, INCLUDING PHOTOCOPYING AND RECORDING, OR BY ANY INFORMATION STORAGE AND RETRIEVAL SYSTEM, WITHOUT PERMISSION IN WRITING FROM TESCO STORES LIMITED.



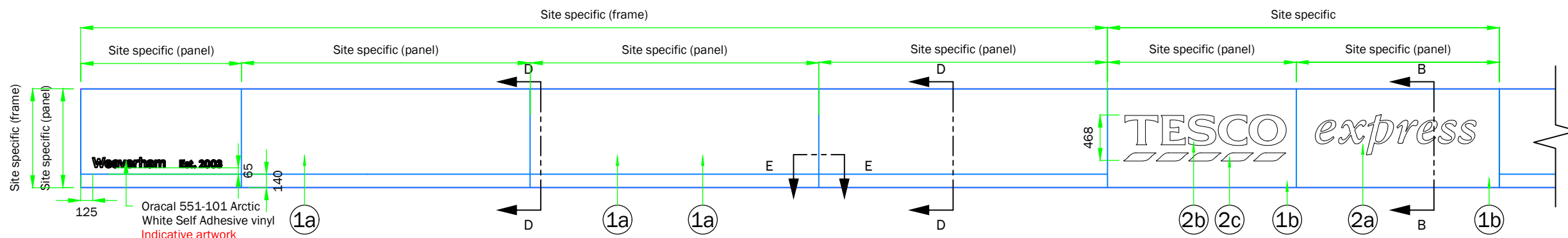

**Fascia Elevation - LHS**  
scale 1:50

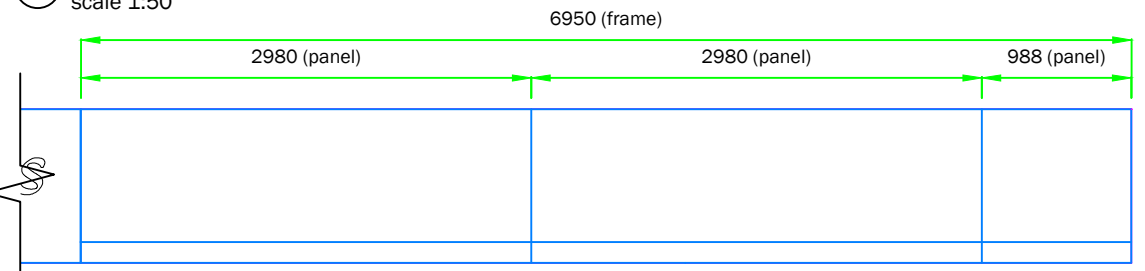

**Fascia Elevation - RHS**  
scale 1:50

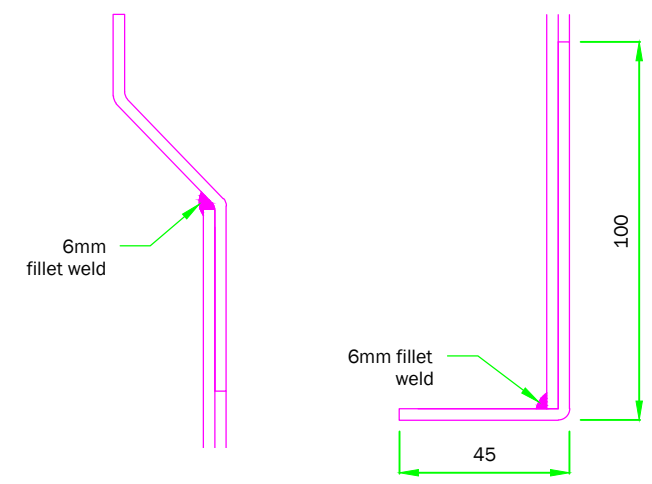

**A Section A-A**  
scale 1:2

**B Section B-B**  
scale 1:2

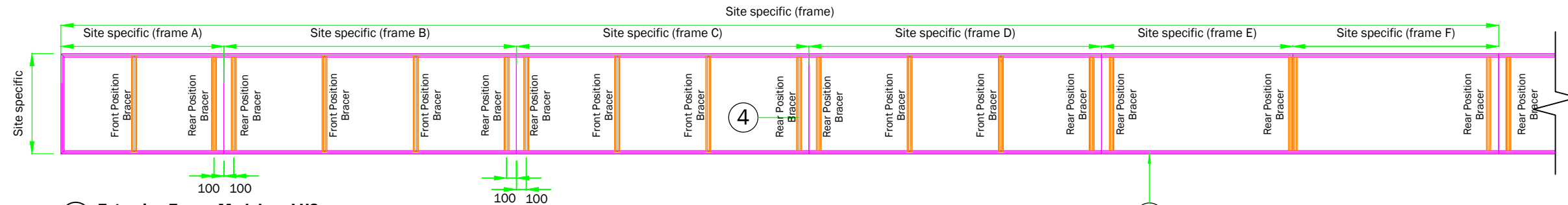

**Extrusion Frame Modules - LHS**  
scale 1:50

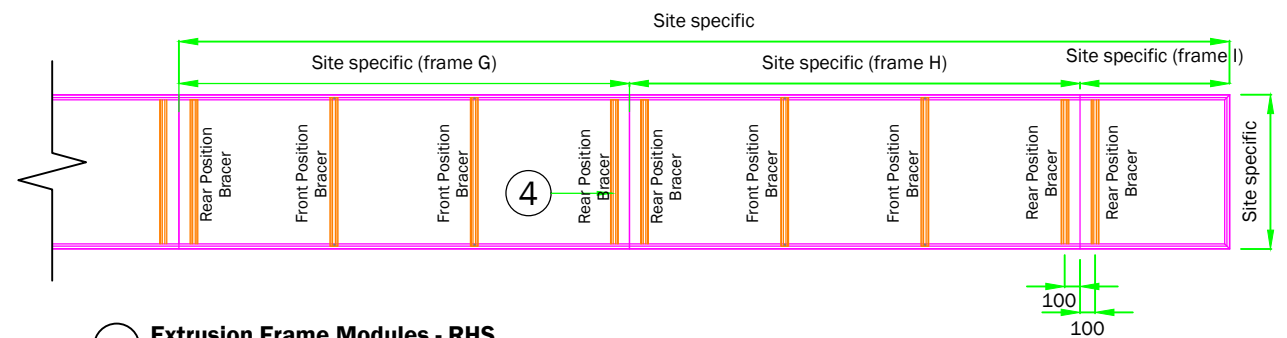

**Extrusion Frame Modules - RHS**  
scale 1:50

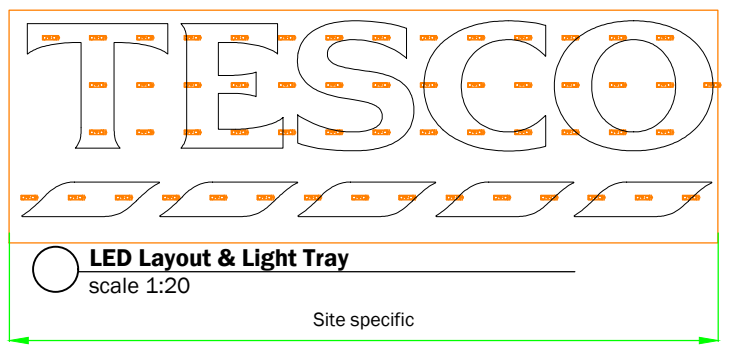

**LED Layout & Light Tray**  
scale 1:20

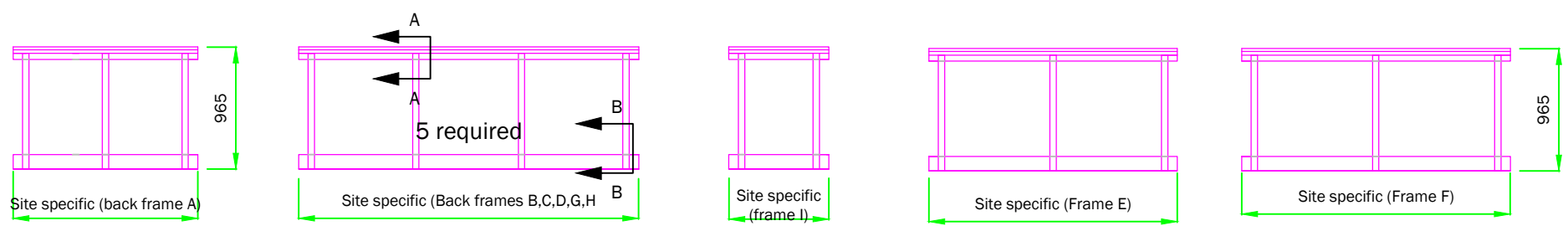
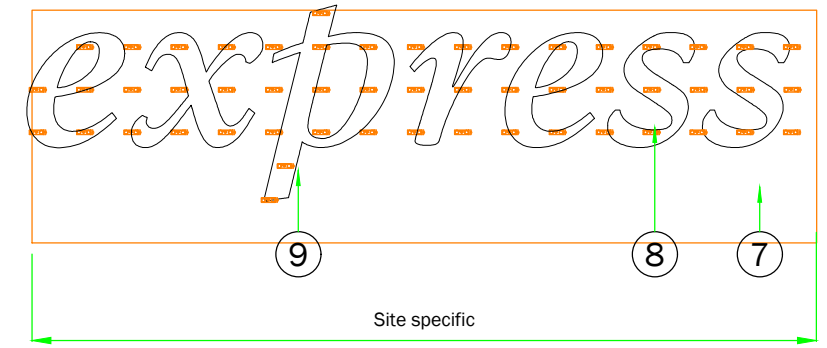

**Back Frames**  
scale 1:50

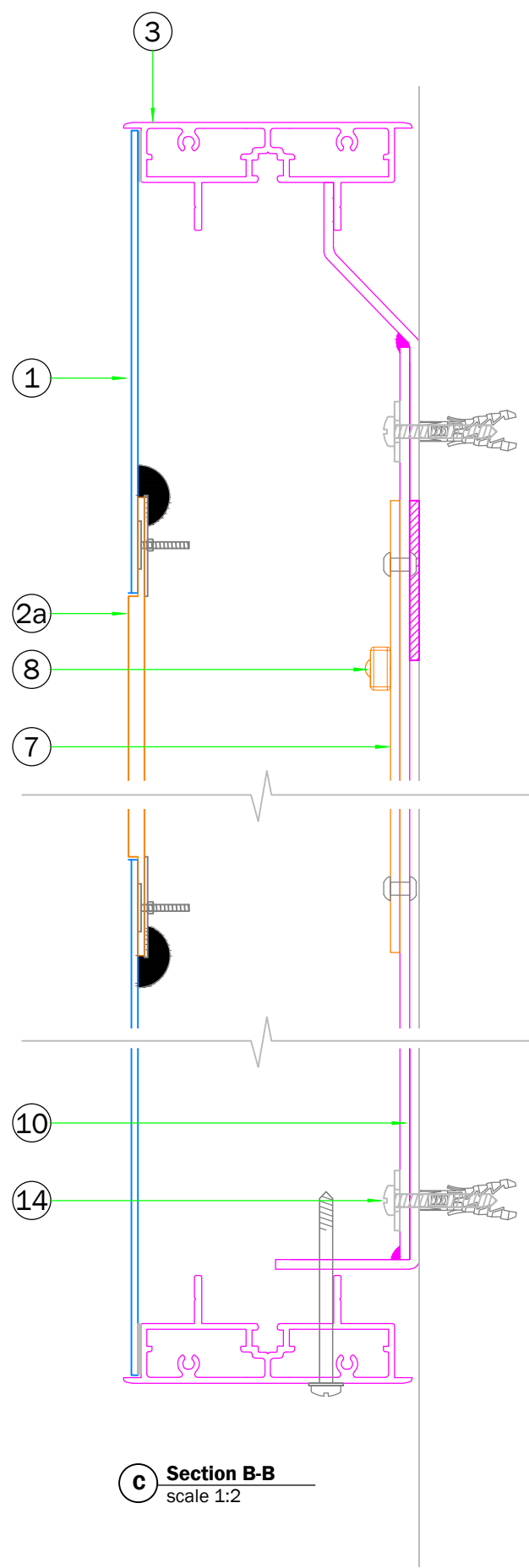

**C Section B-B**  
scale 1:2

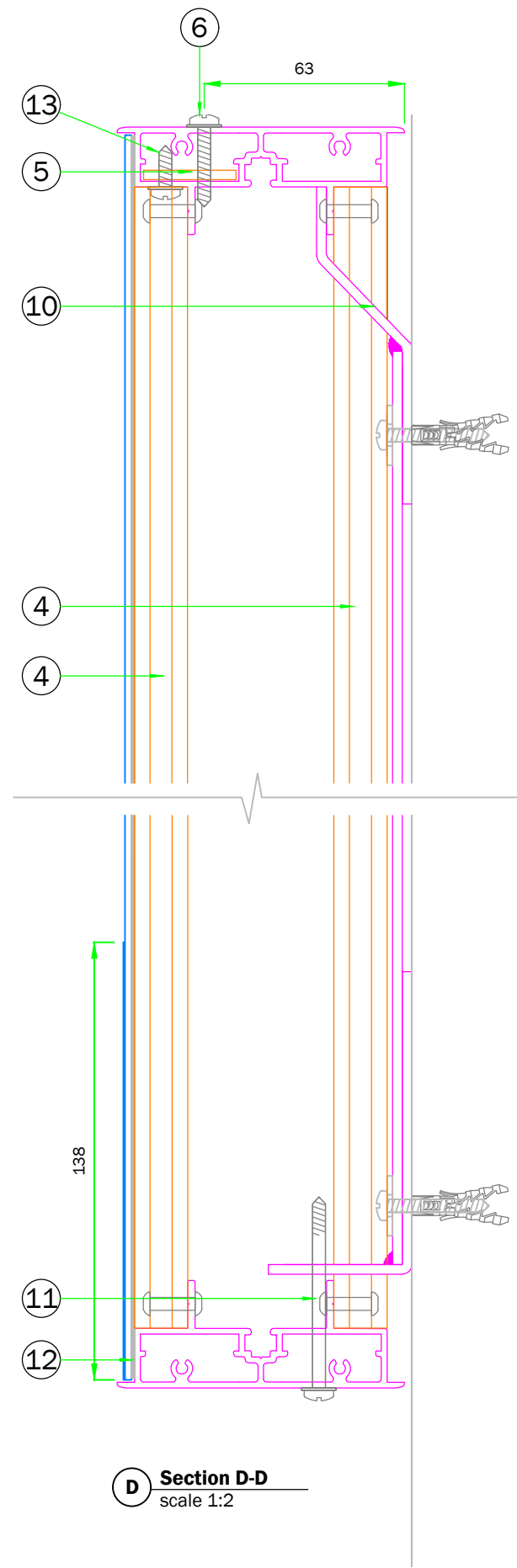

**D Section D-D**  
scale 1:2

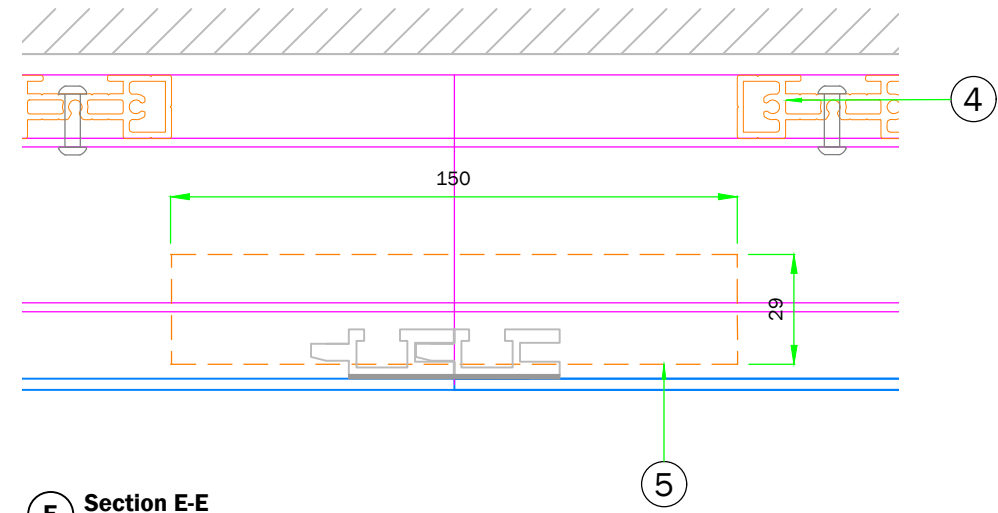

**E Section E-E**  
scale 1:2

WRITTEN SPECIFICATION						
PART No.	DESCRIPTION	PART QTY.	PART WEIGHT (KG)	TOTAL WEIGHT (KG)	MATERIAL USAGE (UOM)	LEAD TIME RISK
1a	2mm aluminium panel, to be powdercoated BLUE RAL 5005, 30% gloss. BROWN ARIZONA OAK strip applied to face, to be digitally printed onto opaque WHITE vinyl - Metamark MD3-301M with Metaguard 300 MG-302 MATT overlaminate.	7	-	-	-	Y
1b	3mm fret cut aluminium panel, to be powdercoated WHITE RAL 9010, 30% gloss	2	-	-	-	Y
2a	'metro' to be 5mm Opal 030 with Avery 5600LD/82A BLUE translucent vinyl applied to face, flush in-laid and fixed to rear of panel with Big Head fixings and Simson ISR 70-03.	1	-	-	-	-
2b	'TESCO' to be 5mm Opal 030 with Avery 4509 RED 431 translucent vinyl applied to face, flush in-laid and fixed to rear of panel with Big Head fixings and Simson ISR 70-03.	1	-	-	-	-
2c	BLIPS to be 5mm Opal 030 with Avery 5600LD/82A BLUE translucent vinyl applied to face, flush in-laid and fixed to rear of panel with Big Head fixings and Simson ISR 70-03.	1	-	-	-	-
3	ASGUK081 extrusion frame, to be BROWN ARIZONA OAK finish	9	-	-	-	-
4	ASGUK016 extrusion bracer, riveted to extrusion frame. To be left mill finish	27	-	-	-	-
5	3mm flat aluminium joining piece, 29x150mm. To be left mill finish	8	-	-	-	-
6	No.8x25mm Flange Head Self Tapper, touched up to match LW0	as req'd	-	-	-	-
7	3mm WHITE Foam PVC LED panel	2	-	-	-	-
8	Tetra MiniMAX 7100K LEDs (GEMM71-2)	100	-	-	-	-
9	MEAN WELL LPV-60-12	1	-	-	-	-
10	Frame work from folded from 3mm aluminium z bracket welded to 45x45x3mm aluminium angle using 50x3mm straps (6mm fillet weld)	9	-	-	-	-
11	No.8x60mm Flange Head Self Tapper, touched up to match to match LW0	as req'd	-	-	-	-
12	Bonding to be 3M 5952 VHB tape. To be applied to full perimeter of frame and also vertical bracers	as req'd	-	-	-	-
13	No.8x13mm Flange Head Self Tapper	as req'd	-	-	-	-
14	Fixings and anchors to suit substrate	as req'd	-	-	-	-

# Internally Illuminated Projecting Sign

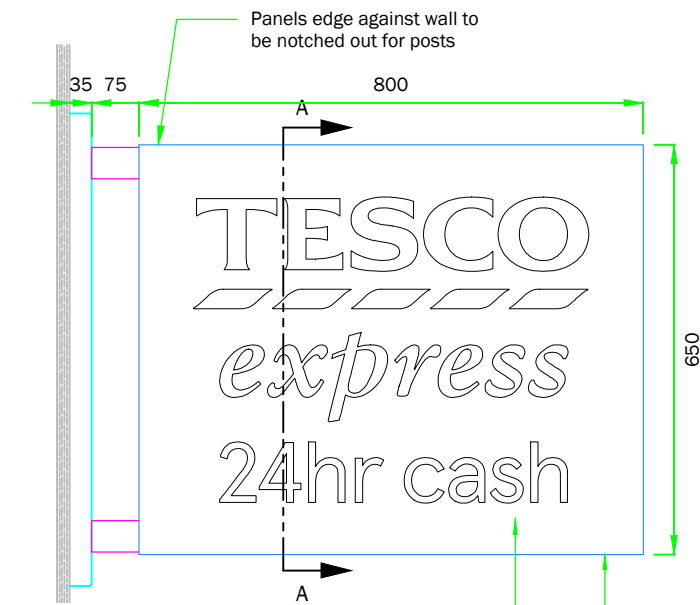

○ **Front Elevation - Remote Version**  
scale 1:12

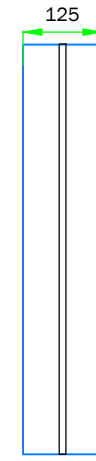

○ **End Elevation**  
scale 1:12

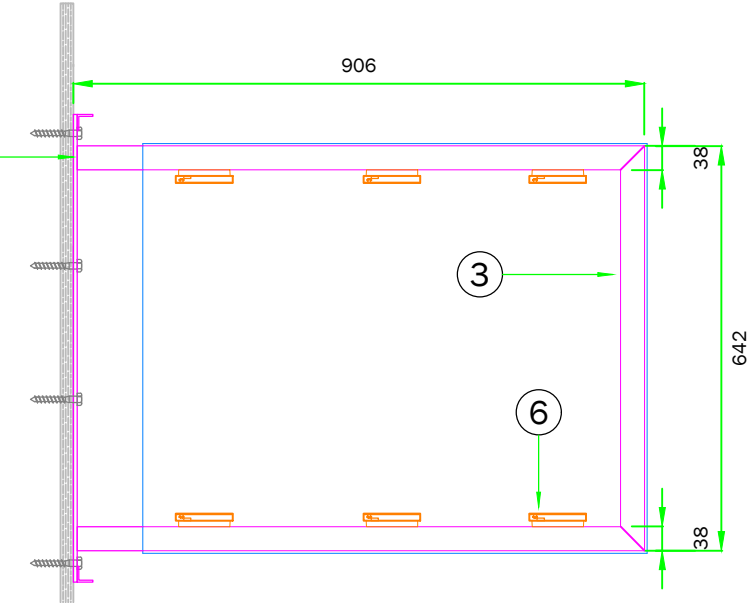

○ **Framework: Front Elevation**  
scale 1:12

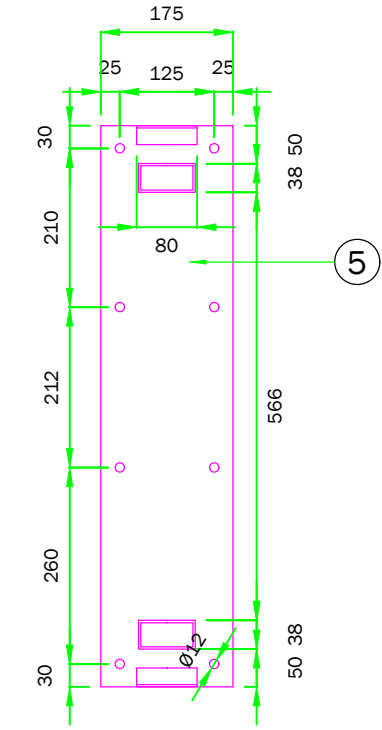

○ **Base Plate: Front Elevation**  
scale 1:10

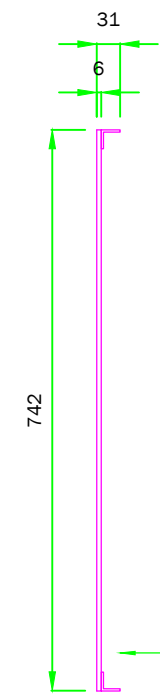

○ **Base Plate: End Elevation**  
scale 1:10

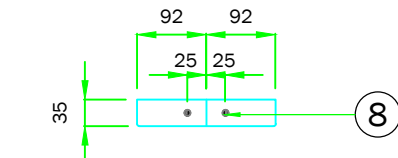

○ **Shroud: Plan View**  
scale 1:12

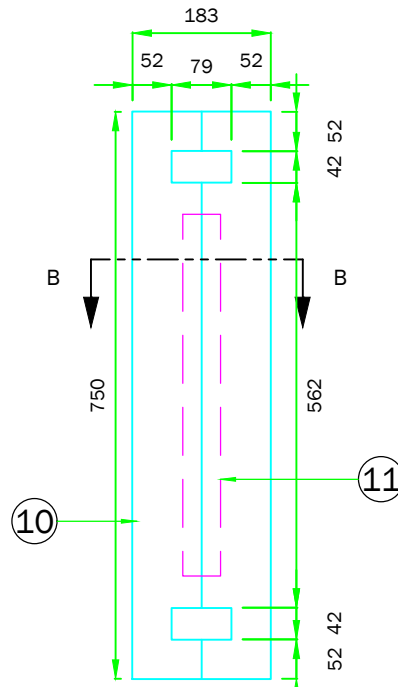

○ **Shroud: Front Elevation**  
scale 1:12

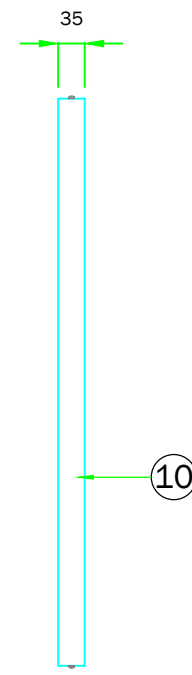

○ **Shroud: End Elevation**  
scale 1:12

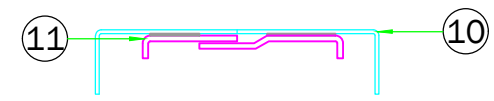

○ **B Section B-B**  
scale 1:4

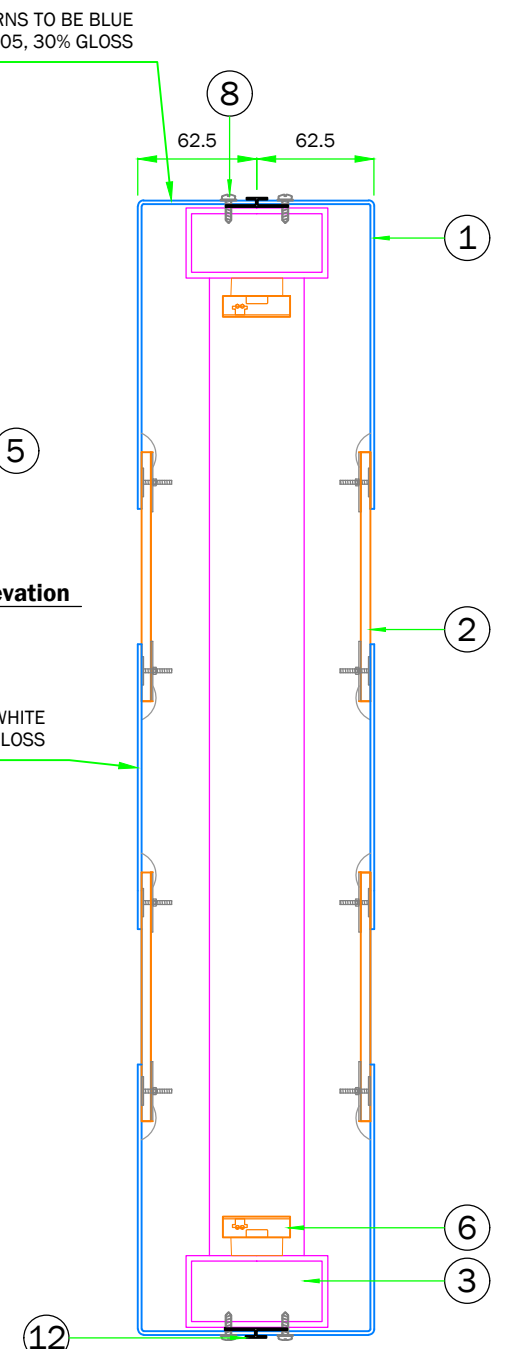

○ **A Section A-A**  
scale 1:4

SPECIFICATION					
Item	Description	Qty.	Tick Box	Initials	
1	Face panels folded from 2mm aluminium, FACE - to be powdercoated WHITE RAL 9010, 30% gloss RETURNS - to be powdercoated BLUE Ral 5005, 30% gloss.	2			
2	5mm acrylic fixed to rear of panel with big head fixings and Simson ISR 70-03. For 'TESCO' Opal 030 with Avery 4509 translucent vinyl applied to face to be used. For blips under 'TESCO' Opal 030 with Avery 5600 LD-082A translucent vinyl applied to face to be used. For 'EXPRESS' letters and additional 'CASH' text, Opal 030 with Avery 5600 LD-082A translucent vinyl applied to face to be used.	as req			
3	2no. framework legs from 75x38x3mm mitred aluminium box section, with 75x38x3mm vertical at end. To be powdercoated BLUE RAL 5005, 30% gloss	1			
4	25x25x3mm aluminium angles welded to top and bottom of base plate for fixing shroud.	2			
5	Base plate from 6mm aluminium welded to frame.	1			
6	Tetra Edge Strip LED Product Code: GEWHBIP2	6			
7	Transformer to suit LEDs.	as req			
8	No.8x13mm flange head self tapping screws for fixing face panels to frame, touched up WHITE RAL 9010, 30% gloss	as req			
9	Suitable fixings for fixing base plate to substrate	8			
10	Shroud (in two halves) fabricated from 2mm aluminium, to be powdercoated BLUE RAL 5005, 30% gloss.	1			
11	Shroud joggle from 3mm aluminium flatbar and joggled flat bar, bonded to inside of shroud using 3M 4980.	1			
12	H-section wallboard extrusion to run perimeter of sign, To be powdercoated BLUE RAL 5005, 30% gloss.	as req			