

Application for Consent to Display an Advertisement(s)

Town and Country Planning (Control of Advertisement) (England) Regulations 2007 (as amended)

Publication of applications on planning authority websites

Please note that the information provided on this application form and in supporting documents may be published on the Authority's website. If you require any further clarification, please contact the Authority's planning department.

Site Location

Disclaimer: We can only make recommendations based on the answers given in the questions.

If you cannot provide a postcode, the description of site location must be completed. Please provide the most accurate site description you can, to help locate the site - for example "field to the North of the Post Office".

Number

Suffix

Property Name

Tesco Express

Address Line 1

Mead Rd,

Address Line 2

Abbeymead,

Address Line 3

Town/city

Gloucester

Postcode

GL4 5GL

Description of site location must be completed if postcode is not known:

Easting (x)

386342

Northing (y)

216489

Description

Applicant Details

Name/Company

Title

Mr

First name

Andy

Surname

Horwood

Company Name

Tesco

Address

Address line 1

Kestrel Way

Address line 2

Address line 3

Town/City

Welwyn Garden City

Country

United Kingdom

Postcode

AL7 1GB

Are you an agent acting on behalf of the applicant?

Yes

No

Contact Details

Primary number

***** REDACTED *****

Secondary number

Fax number

Email address

Type of Proposed Advertisement(s)

Please describe the proposed advertisement(s)

Advertisement Type:

Fascia Sign

Height:

1.1 metres

Width:

4.78 metres

Depth:

0.125 metres

What is the height from the ground to the base of the advertisement?:

2.9 metres

What is the maximum projection of the advertisement from the face of the building?:

0.125 metres

What is the maximum height of any of the individual letters and symbols?:

31 centimetres

What materials will the advertisement be made of?:

2mm formed Aluminum

The colour of text and background:

As shown in _2346_Gloucester Mead_ProposedElevations_Sign 2

Will the advertisement be illuminated?:

Yes

Will the advertisement be illuminated internally or externally?:

Internally

Illuminance levels:

350 cd/m²

Will the illumination be static or intermittent?:

Static

Advertisement Type:

Fascia Sign

Height:

1.1 metres

Width:

5.02 metres

Depth:

0.125 metres

What is the height from the ground to the base of the advertisement?:

2.9 metres

What is the maximum projection of the advertisement from the face of the building?:

0.125 metres

What is the maximum height of any of the individual letters and symbols?:

10 centimetres

What materials will the advertisement be made of?:

2mm formed Aluminum

The colour of text and background:

As shown in _2346_Gloucester Mead_ProposedElevations_Sign 3

Will the advertisement be illuminated?:

Advertisement Type:

Fascia Sign

Height:

1 metres

Width:

6.61 metres

Depth:

0.125 metres

What is the height from the ground to the base of the advertisement?:

2.38 metres

What is the maximum projection of the advertisement from the face of the building?:

0.125 metres

What is the maximum height of any of the individual letters and symbols?:

46 centimetres

What materials will the advertisement be made of?:

2mm formed Aluminum

The colour of text and background:

As shown in _2346_Gloucester Mead_ProposedElevations_Sign 1

Will the advertisement be illuminated?:

Yes

Will the advertisement be illuminated internally or externally?:

Internally

Illuminance levels:

350 cd/m²

Will the illumination be static or intermittent?:

Static

Advertisement Type:

Projecting or Hanging Sign

Height:

0.65 metres

Width:

0.8 metres

Depth:

0.125 metres

What is the height from the ground to the base of the advertisement?:

2.92 metres

What is the maximum projection of the advertisement from the face of the building?:

0.8 metres

What is the maximum height of any of the individual letters and symbols?:

20 centimetres

What materials will the advertisement be made of?:

2mm formed Aluminum

The colour of text and background:

As shown in _2346_Gloucester Mead_ProposedElevations_Sign 4

Will the advertisement be illuminated?:

Yes

Will the advertisement be illuminated internally or externally?:

Internally

Illuminance levels:

350 cd/m²

Will the illumination be static or intermittent?:

Static

Advertisement Type:

Other type

Height:

2.75 metres

Width:

1.1 metres

Depth:

0.01 metres

What is the height from the ground to the base of the advertisement?:

0.05 metres

What is the maximum projection of the advertisement from the face of the building?:

0.003 metres

What is the maximum height of any of the individual letters and symbols?:

20 centimetres

What materials will the advertisement be made of?:

3mm vinyl

The colour of text and background:

As shown in _2346_Gloucester Mead_ProposedElevations_Sign 5

Will the advertisement be illuminated?:**Advertisement Type:**

Other type

Height:

2.12 metres

Width:

1.11 metres

Depth:

0.01 metres

What is the height from the ground to the base of the advertisement?:

0.05 metres

What is the maximum projection of the advertisement from the face of the building?:

0.003 metres

What is the maximum height of any of the individual letters and symbols?:

20 centimetres

What materials will the advertisement be made of?:

3mm vinyl

The colour of text and background:

As shown in _2346_Gloucester Mead_ProposedElevations_Sign 6

Will the advertisement be illuminated?:**Advertisement Type:**

Other type

Height:

2.12 metres

Width:

2.33 metres

Depth:

0.01 metres

What is the height from the ground to the base of the advertisement?:

0.05 metres

What is the maximum projection of the advertisement from the face of the building?:

0.003 metres

What is the maximum height of any of the individual letters and symbols?:

20 centimetres

What materials will the advertisement be made of?:

3mm vinyl

The colour of text and background:

As shown in _2346_Gloucester Mead_ProposedElevations_Sign 7

Will the advertisement be illuminated?:

Advertisement Type:

Other type

Height:

2.03 metres

Width:

1.78 metres

Depth:

0.01 metres

What is the height from the ground to the base of the advertisement?:

0.05 metres

What is the maximum projection of the advertisement from the face of the building?:

0.003 metres

What is the maximum height of any of the individual letters and symbols?:

20 centimetres

What materials will the advertisement be made of?:

3mm vinyl

The colour of text and background:

As shown in _2346_Gloucester Mead_ProposedElevations_Sign 8

Will the advertisement be illuminated?:

Advertisement Type:

Other type

Height:

1.7 metres

Width:

0.8 metres

Depth:

0.01 metres

What is the height from the ground to the base of the advertisement?:

0.21 metres

What is the maximum projection of the advertisement from the face of the building?:

0.003 metres

What is the maximum height of any of the individual letters and symbols?:

20 centimetres

What materials will the advertisement be made of?:

3mm vinyl

The colour of text and background:

As shown in _2346_Gloucester Mead_ProposedElevations_Sign 9

Will the advertisement be illuminated?:

Advertisement Type:

Other type

Height:

1 metres

Width:

3.5 metres

Depth:

0.01 metres

What is the height from the ground to the base of the advertisement?:

0.82 metres

What is the maximum projection of the advertisement from the face of the building?:

0.005 metres

What is the maximum height of any of the individual letters and symbols?:

20 centimetres

What materials will the advertisement be made of?:

5mm dibond panel

The colour of text and background:

As shown in _2346_Gloucester Mead_ProposedElevations_Sign 10

Will the advertisement be illuminated?:**Advertisement Type:**

Other type

Height:

1 metres

Width:

3.5 metres

Depth:

0.01 metres

What is the height from the ground to the base of the advertisement?:

0.82 metres

What is the maximum projection of the advertisement from the face of the building?:

0.005 metres

What is the maximum height of any of the individual letters and symbols?:

20 centimetres

What materials will the advertisement be made of?:

5mm dibond panel

The colour of text and background:

As shown in _2346_Gloucester Mead_ProposedElevations_Sign 11

Will the advertisement be illuminated?:

Please describe each of the 'Other type(s)' of advertising proposed

5x vinyl, 2x dibond panel

Location of Advertisement(s)

Is the advertisement(s) you are applying for already in place?

Yes

No

Is an existing advertisement(s) to be removed and replaced by the advertisement(s) in this proposal?

Yes

No

Not Applicable

If Yes to either or both above, please show the existing sign(s) on an elevation drawing or photograph and state the references for the drawing(s) or photograph(s)

Will the proposed advertisement(s) project over a footpath or other public highway?

- Yes
 No

Advertisement(s) Period

Please state the period of time for which consent is sought for the advertisement

From Date

09/02/2022

To Date

09/02/2027

Neighbour and Community Consultation

Have you consulted your neighbours or the local community about the proposal?

- Yes
 No

Site Visit

Can the site be seen from a public road, public footpath, bridleway or other public land?

- Yes
 No

If the planning authority needs to make an appointment to carry out a site visit, whom should they contact?

- The agent
 The applicant
 Other person

Pre-application Advice

Has assistance or prior advice been sought from the local authority about this application?

- Yes
 No

Interest In the Land

Does the applicant own the land or buildings where the adverts are to be placed?

- Yes
 No

If No, has the permission of the owner or any other person entitled to give permission for the display of an advertisement been obtained?

Yes

No

Authority Employee/Member

With respect to the Authority, is the applicant and/or agent one of the following:

(a) a member of staff

(b) an elected member

(c) related to a member of staff

(d) related to an elected member

It is an important principle of decision-making that the process is open and transparent.

For the purposes of this question, "related to" means related, by birth or otherwise, closely enough that a fair-minded and informed observer, having considered the facts, would conclude that there was bias on the part of the decision-maker in the Local Planning Authority.

Do any of the above statements apply?

Yes

No

Declaration

I / We hereby apply for Consent to display an advertisement as described in this form and accompanying plans/drawings and additional information. I / We confirm that, to the best of my/our knowledge, any facts stated are true and accurate and any opinions given are the genuine options of the persons giving them. I / We also accept that: Once submitted, this information will be transmitted to the Local Planning Authority and, once validated by them, be made available as part of a public register and on the authority's website; our system will automatically generate and send you emails in regard to the submission of this application.

I / We agree to the outlined declaration

Signed

Andy Horwood

Date

10/02/2022

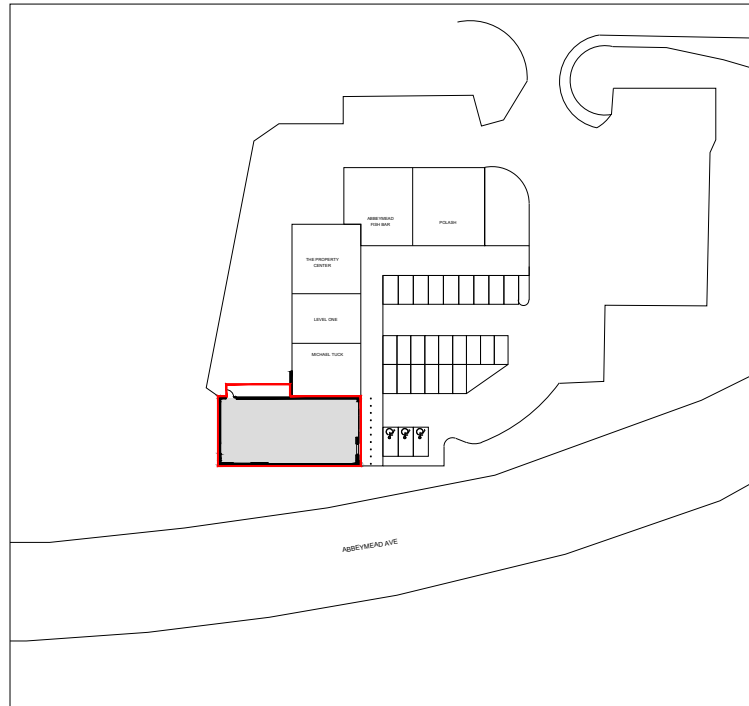

— Site Boundary shown in Red line

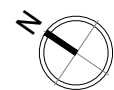
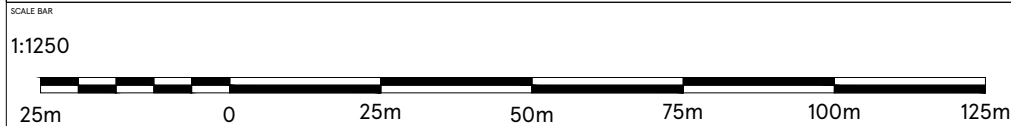

DRAWING NO
01_2346_01A

SCALE
1:1250@A4

DATE
07.02.2022

CHECKED BY
SHIKHA

DRAWN BY
MATHURAA

STORE TYPE
EXPRESS

STORE NAME
GLOUCESTER MEAD ROAD

CONTENT
LOCATION PLAN

TESCO
FEASIBILITY PLANNING

THE COPYRIGHT AND ALL OTHER RIGHTS IN AND RELATIVE TO THIS PUBLICATION BELONG TO AND ARE THE SOLE PROPERTY OF TESCO STORES LIMITED. ALL RIGHTS ARE RESERVED. NOTHING IN THIS DOCUMENT IS TO BE REPRODUCED OR TRANSMITTED IN ANY FORM OR BY ANY MEANS, ELECTRONIC OR MECHANICAL, INCLUDING PHOTOCOPYING, RECORDING OR FROM ANY RETRIEVAL SYSTEM WITHOUT THE PRIOR WRITTEN LICENCE FROM THE COMPANY. © 2022 TESCO STORES LIMITED.



SCALE BAR

1:100

2m 0 2m 4m 6m 8m 10m

DRAWING NO
02_2346_02D

SCALE
1:200@A3

CHECKED BY
SHIKHA

DRAWN BY
ARYA

STORE TYPE
EXPRESS

STORE NAME
GLOUCESTER MEAD RD

CONTENT
EXISTING SITE PLAN_ADV

TESCO
FEASIBILITY PLANNING

THE COPYRIGHT AND ALL OTHER RIGHTS IN THIS PUBLICATION BELONG TO AND ARE THE SOLE PROPERTY OF TESCO STORES LIMITED. ALL RIGHTS ARE RESERVED. NEITHER THE WHOLE NOR ANY PART OF THIS PUBLICATION MAY BE REPRODUCED OR TRANSMITTED IN ANY FORM OR BY ANY ELECTRONIC OR MECHANICAL MEANS INCLUDING PHOTOCOPYING AND RECORDING OR FROM ANY RETRIEVAL SYSTEM WITHOUT THE PRIOR WRITTEN LICENCE FROM THE OWNER. © TESCO STORES LIMITED.



SOUTH ELEVATION

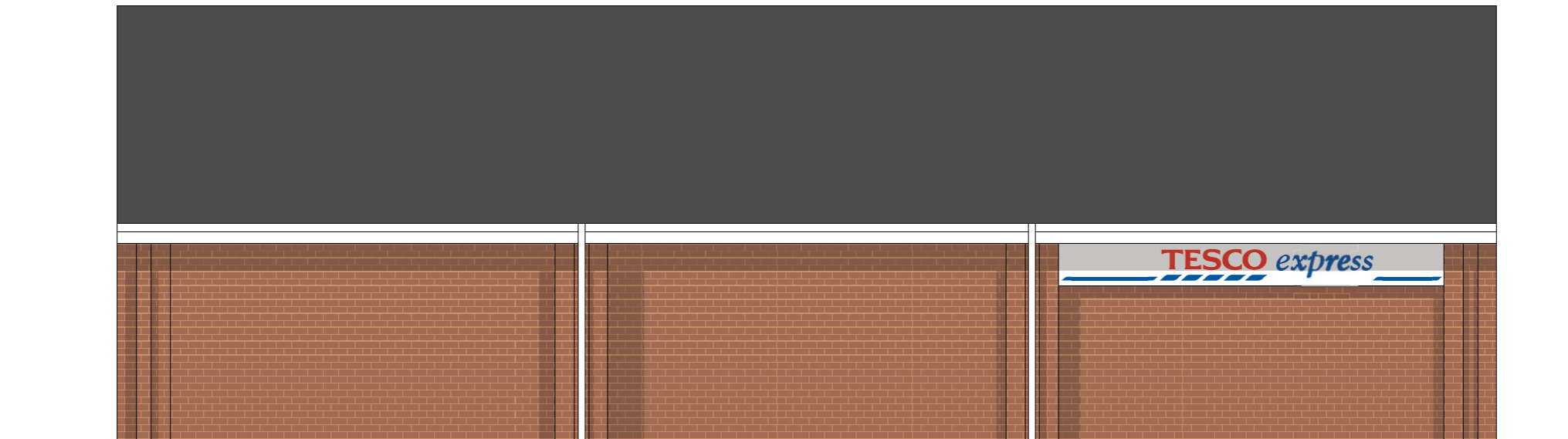

WEST ELEVATION

SCALE BAR

1:100

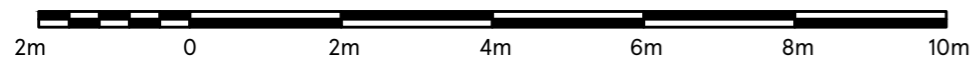

DRAWING NO
03_2346_03C

SCALE
1:100@A3

CHECKED BY
SHIKHA
DRAWN BY
DEEKSHA

DATE
31.12.2021

STORE TYPE
EXPRESS

STORE NAME
GLOUCESTER MEAD RD

CONTENT
EXISTING ELEVATIONS

TESCO
FEASIBILITY PLANNING

BELONG TO AND ARE THE SOLE PROPERTY OF TESCO STORES LIMITED. ALL RIGHTS ARE RESERVED. NEITHER THE WHOLE NOR ANY PART OF THIS PUBLICATION MAY BE REPRODUCED OR TRANSMITTED IN ANY FORM OR BY ANY ELECTRONIC OR MECHANICAL MEANS INCLUDING PHOTOCOPYING AND RECORDING OR FROM ANY RETRIEVAL SYSTEM WITHOUT THE PRIOR WRITTEN LICENCE FROM THE OWNER © 1997 TESCO STORES LIMITED.

New Box fascia in Aluminium powder coated white RAL 9010. Internal illumination to letters only. Tesco in Opal 030 Avery 4509 Red 431, And Express & blips in Opal 030-Avery 5600 LD/082A blue, translucent acrylic letters applied to face.

SIGN 2
4780x1100mm

SIGN 3
5020x1100mm

New non-illuminated box fascia in Aluminium, powder coated Blue RAL 5005, 30% Gloss with Brown Arizona Oak woodtex strip to base. Store Address and Est. year vinyl lettering applied to new fascia. Store Address and Est. year vinyl lettering applied to new fascia,

New Projecting Sign in Aluminum Powder coated white RAL 9010. Internal illumination to Acrylic letters only. Tesco in Opal 030 Avery 4509 Red 431, and Express & blips in Opal 030-Avery 5600 LD/082A blue, translucent acrylic letters applied to face. Sides, top and bottom to be blue as per fascia.

SIGN 4
800x650mm

Vinyl to be applied around ATM. Colour - Pantone 293, with print as per artwork. White spots on blue for vinyl panel. Blue header panel with white text to read 'Cash Machine'.

SIGN 5
1100x2740mm



SIGN 9
800x1700mm

New vinyls to be applied internally up to full height to the glazing. Avery 800-01 off white Chiffon Vinyl to be applied on reverse.

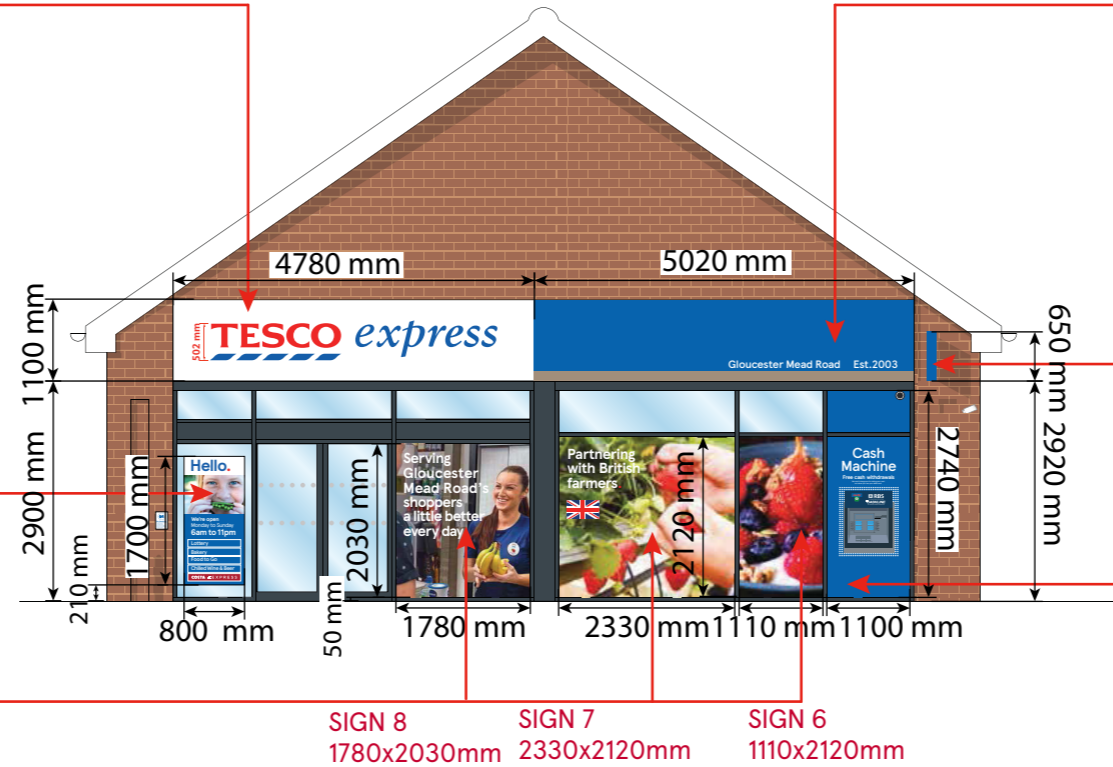

SOUTH ELEVATION

New Box fascia in Aluminium powder coated white RAL 9010. Internal illumination to letters only. Tesco in Opal 030 Avery 4509 Red 431, And Express & blips in Opal 030-Avery 5600 LD/082A blue, translucent acrylic letters applied to face.

SIGN 1
6610x1000mm

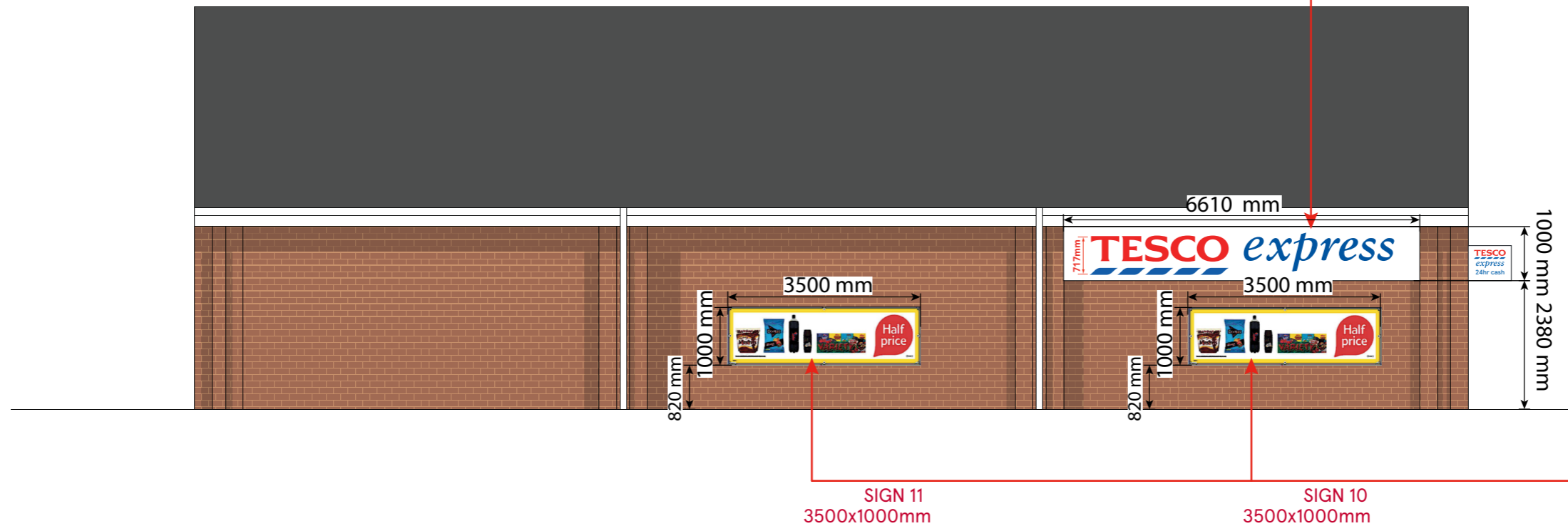

New Wall mounted promotional banner with metal frame.

WEST ELEVATION

SCALE BAR

1:100

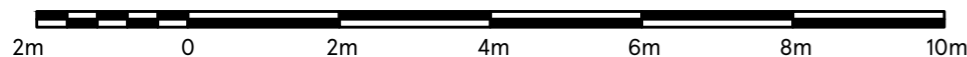

DRAWING NO
03_2346_03D

STORE TYPE
EXPRESS

SCALE
1:100@A3

DATE
31.12.2021

STORE NAME
GLOUCESTER MEAD RD

CHECKED BY
SHIKHA
DRAWN BY
DEEKSHA

CONTENT
PROPOSED ELEVATIONS

TESCO
FEASIBILITY PLANNING

BELONG TO AND ARE THE SOLE PROPERTY OF TESCO STORES LIMITED. ALL RIGHTS ARE RESERVED. NEITHER THE WHOLE NOR ANY PART OF THIS PUBLICATION MAY BE REPRODUCED OR TRANSMITTED IN ANY FORM OR BY ANY ELECTRONIC OR MECHANICAL MEANS INCLUDING PHOTOCOPYING AND RECORDING OR FROM ANY RETRIEVAL SYSTEM WITHOUT THE PRIOR WRITTEN LICENCE FROM THE OWNER © 1997 TESCO STORES LIMITED.

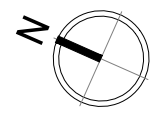
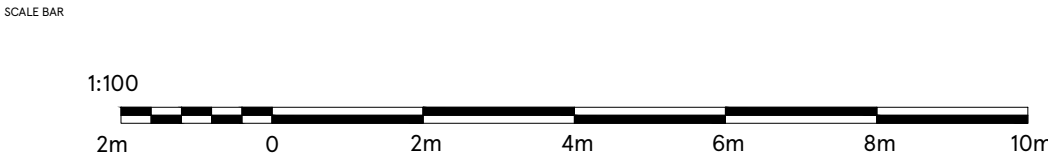

DRAWING NO
02_2346_02E

SCALE
1:100@A3

CHECKED BY
SHIKHA

DRAWN BY
ARYA

STORE TYPE
EXPRESS

STORE NAME
GLOUCESTER MEAD RD

CONTENT
EXISTING PLAN_ADV

TESCO
FEASIBILITY PLANNING

THE COPYRIGHT AND ALL OTHER RIGHTS IN THIS PUBLICATION BELONG TO AND ARE THE SOLE PROPERTY OF TESCO STORES LIMITED. ALL RIGHTS ARE RESERVED. NEITHER THE WHOLE NOR ANY PART OF THIS PUBLICATION MAY BE REPRODUCED OR TRANSMITTED IN ANY FORM OR BY ANY ELECTRONIC OR MECHANICAL MEANS INCLUDING PHOTOCOPYING AND RECORDING OR FROM ANY RETRIEVAL SYSTEM WITHOUT THE PRIOR WRITTEN LICENCE FROM THE OWNER. © TESCO STORES LIMITED

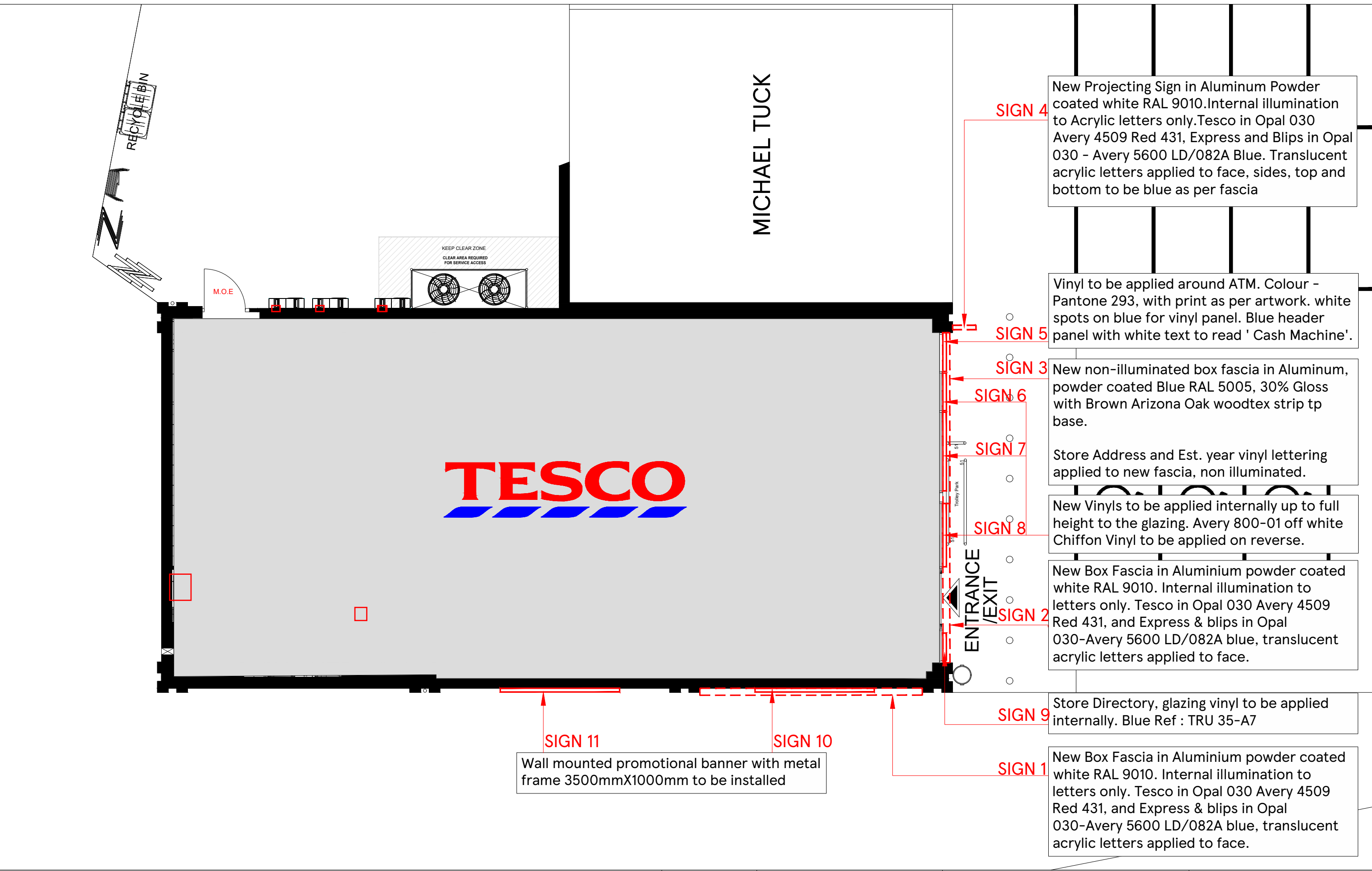

SIGN 4
 New Projecting Sign in Aluminum Powder coated white RAL 9010. Internal illumination to Acrylic letters only. Tesco in Opal 030 Avery 4509 Red 431, Express and Blips in Opal 030 - Avery 5600 LD/082A Blue. Translucent acrylic letters applied to face, sides, top and bottom to be blue as per fascia

SIGN 5
 Vinyl to be applied around ATM. Colour - Pantone 293, with print as per artwork. white spots on blue for vinyl panel. Blue header panel with white text to read 'Cash Machine'.

SIGN 3
 New non-illuminated box fascia in Aluminum, powder coated Blue RAL 5005, 30% Gloss with Brown Arizona Oak woodtex strip tp base.

SIGN 6
 Store Address and Est. year vinyl lettering applied to new fascia, non illuminated.

SIGN 7
 New Vinyls to be applied internally up to full height to the glazing. Avery 800-01 off white Chiffon Vinyl to be applied on reverse.

SIGN 8
 New Box Fascia in Aluminium powder coated white RAL 9010. Internal illumination to letters only. Tesco in Opal 030 Avery 4509 Red 431, and Express & blips in Opal 030-Avery 5600 LD/082A blue, translucent acrylic letters applied to face.

SIGN 9
 Store Directory, glazing vinyl to be applied internally. Blue Ref : TRU 35-A7

SIGN 1
 New Box Fascia in Aluminium powder coated white RAL 9010. Internal illumination to letters only. Tesco in Opal 030 Avery 4509 Red 431, and Express & blips in Opal 030-Avery 5600 LD/082A blue, translucent acrylic letters applied to face.

SIGN 11
SIGN 10
 Wall mounted promotional banner with metal frame 3500mmX1000mm to be installed

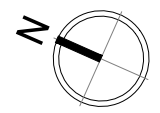
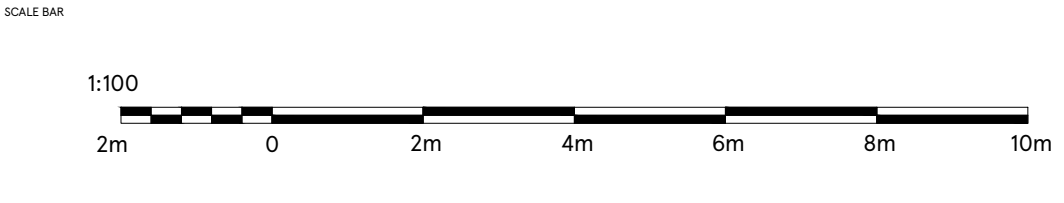

DRAWING NO 02_2346_02F	DATE 30.12.2021
SCALE 1:100@A3	CHECKED BY SHIKHA
DRAWN BY ARYA	

STORE TYPE EXPRESS
STORE NAME GLOUCESTER MEAD RD
CONTENT PROPOSED PLAN_ADV

TESCO
 FEASIBILITY PLANNING

RELING TO AND ARE THE SOLE PROPERTY OF TESCO STORES LIMITED. ALL RIGHTS ARE RESERVED. NEITHER THE WHOLE NOR ANY PART OF THIS PUBLICATION MAY BE REPRODUCED OR TRANSMITTED IN ANY FORM OR BY ANY ELECTRONIC OR MECHANICAL MEANS INCLUDING PHOTOCOPYING AND RECORDING OR FROM ANY RETRIEVAL SYSTEM WITHOUT THE PRIOR WRITTEN LICENCE FROM THE OWNER. © TESCO STORES LIMITED

Internally Illuminated Projecting Sign

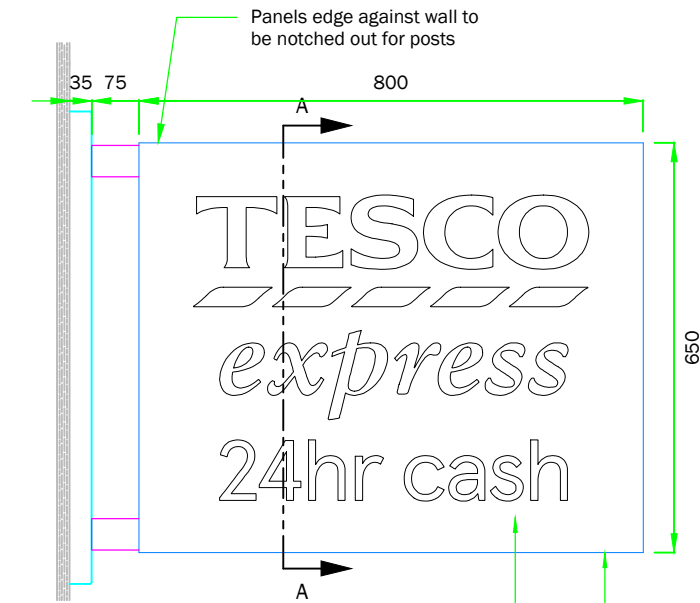

○ **Front Elevation - Remote Version**
scale 1:12

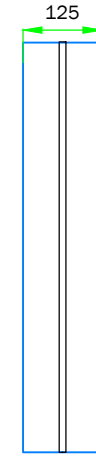

○ **End Elevation**
scale 1:12

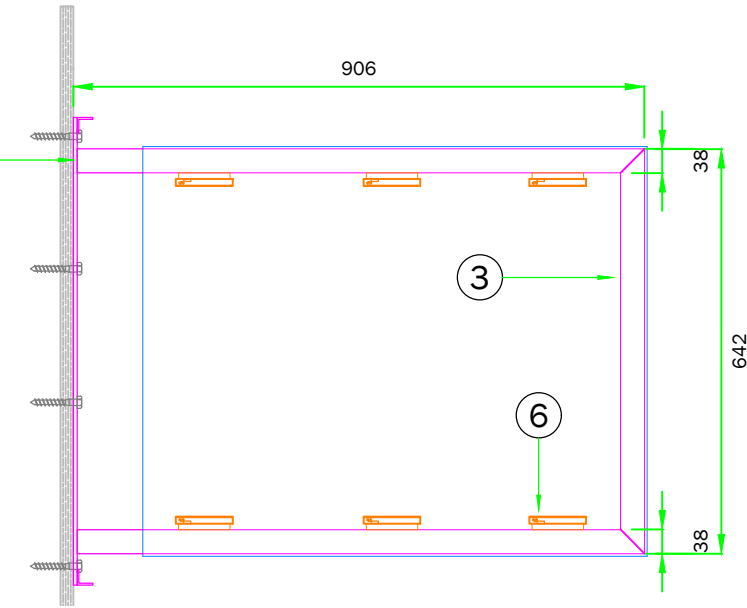

○ **Framework: Front Elevation**
scale 1:12

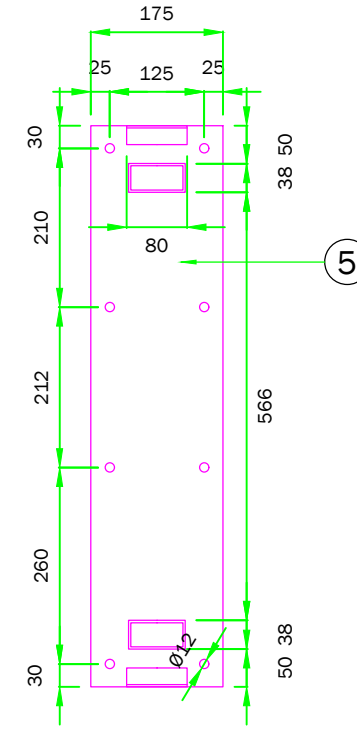

○ **Base Plate: Front Elevation**
scale 1:10

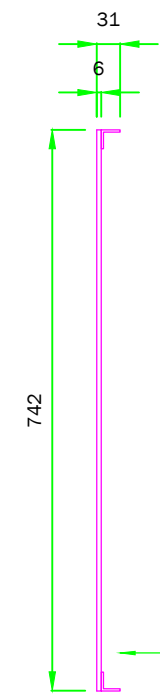

○ **Base Plate: End Elevation**
scale 1:10

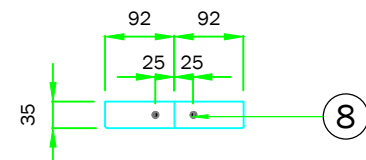

○ **Shroud: Plan View**
scale 1:12

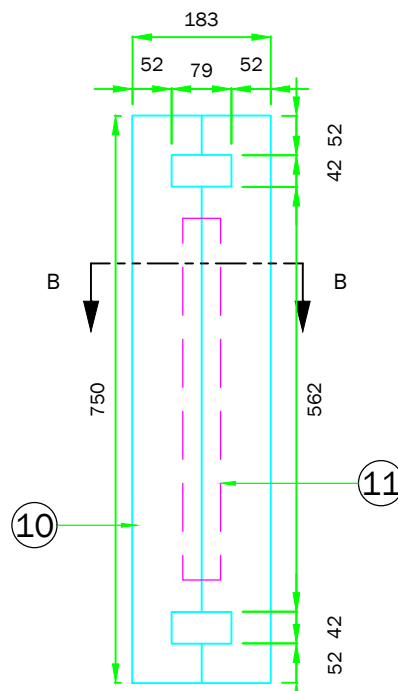

○ **Shroud: Front Elevation**
scale 1:12

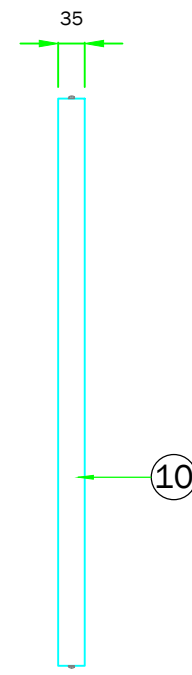

○ **Shroud: End Elevation**
scale 1:12



○ **B Section B-B**
scale 1:4

RETURNS TO BE BLUE RAL 5005, 30% GLOSS

FACE TO BE WHITE RAL 9010, 30% GLOSS

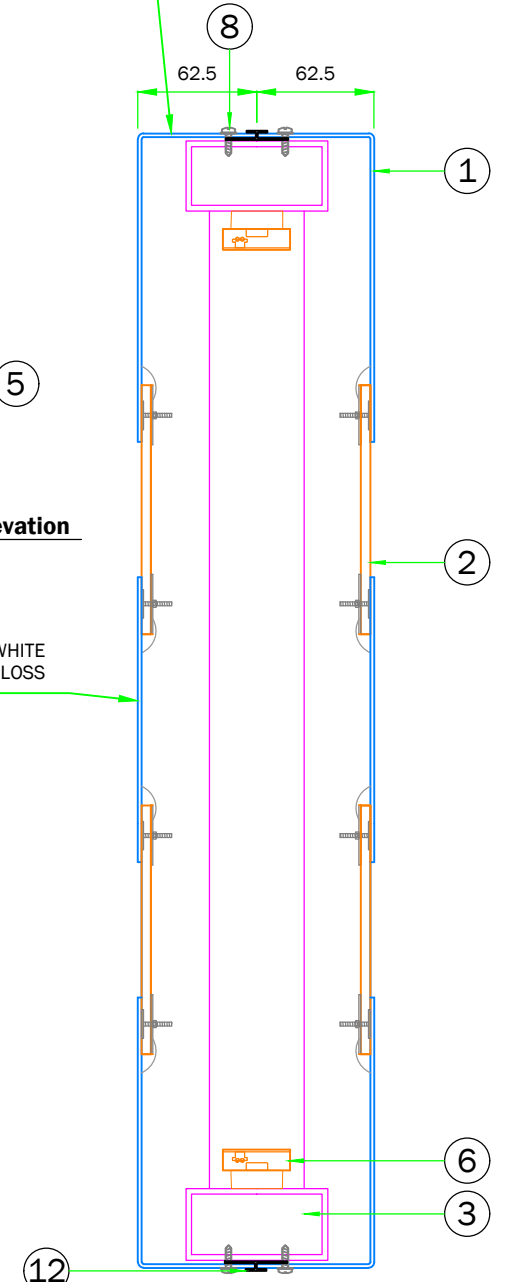

○ **A Section A-A**
scale 1:4

SPECIFICATION					
Item	Description	Qty.	Tick Box	Initials	
1	Face panels folded from 2mm aluminium, FACE - to be powdercoated WHITE RAL 9010, 30% gloss RETURNS - to be powdercoated BLUE Ral 5005, 30% gloss.	2			
2	5mm acrylic fixed to rear of panel with big head fixings and Simson ISR 70-03. For 'TESCO' Opal 030 with Avery 4509 translucent vinyl applied to face to be used. For blips under 'TESCO' Opal 030 with Avery 5600 LD-082A translucent vinyl applied to face to be used. For 'EXPRESS' letters and additional 'CASH' text, Opal 030 with Avery 5600 LD-082A translucent vinyl applied to face to be used.	as req			
3	2no. framework legs from 75x38x3mm mitred aluminium box section, with 75x38x3mm vertical at end. To be powdercoated BLUE RAL 5005, 30% gloss	1			
4	25x25x3mm aluminium angles welded to top and bottom of base plate for fixing shroud.	2			
5	Base plate from 6mm aluminium welded to frame.	1			
6	Tetra Edge Strip LED Product Code: GEWHBIP2	6			
7	Transformer to suit LEDs.	as req			
8	No.8x13mm flange head self tapping screws for fixing face panels to frame, touched up WHITE RAL 9010, 30% gloss	as req			
9	Suitable fixings for fixing base plate to substrate	8			
10	Shroud (in two halves) fabricated from 2mm aluminium, to be powdercoated BLUE RAL 5005, 30% gloss.	1			
11	Shroud joggle from 3mm aluminium flatbar and joggled flat bar, bonded to inside of shroud using 3M 4980.	1			
12	H-section wallboard extrusion to run perimeter of sign, To be powdercoated BLUE RAL 5005, 30% gloss.	as req			

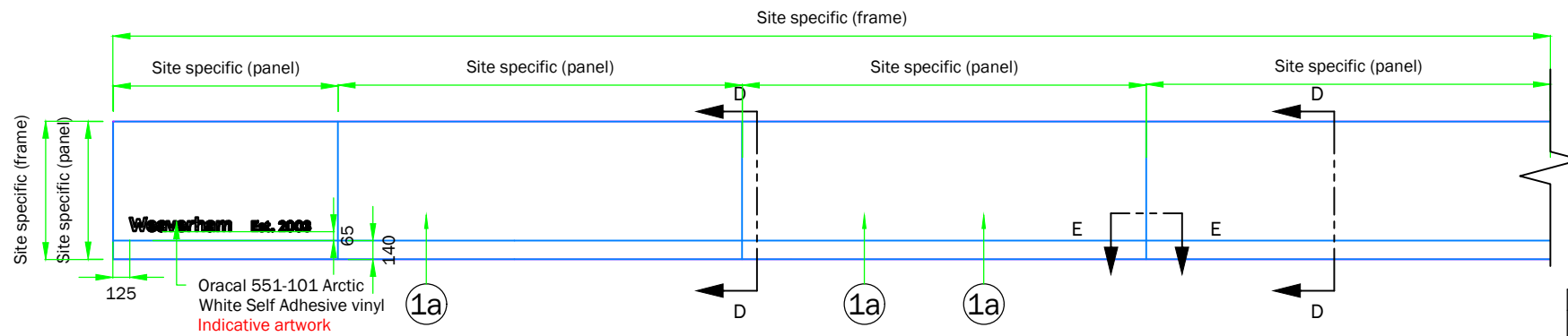

Fascia Elevation - LHS
scale 1:50

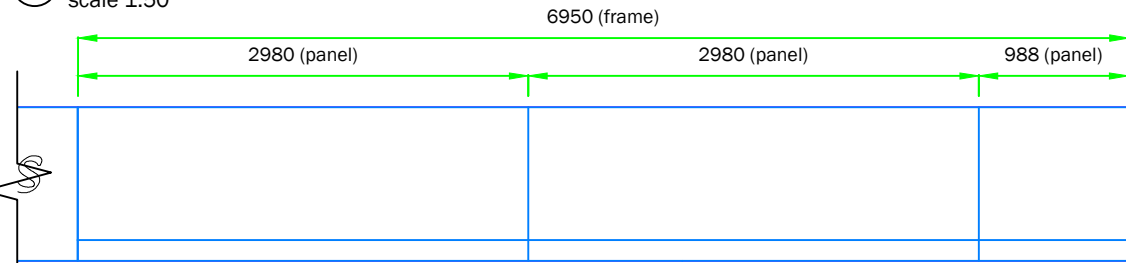

Fascia Elevation - RHS
scale 1:50

WRITTEN SPECIFICATION						
PART No.	DESCRIPTION	PART QTY.	PART WEIGHT (KG)	TOTAL WEIGHT (KG)	MATERIAL USAGE (LDM)	LEAD TIME RISK
1a	2mm aluminium panel, to be powdercoated BLUE RAL 9005, 30% gloss, BROWN ARIZONA OAK strip applied to face, to be digitally printed onto opaque WHITE vinyl -Metamark MD3-301M with Metaguard 300 MG-302 MATT overlaminate.	7	-	-	-	Y
1b	3mm fret cut aluminium panel, to be powdercoated WHITE RAL 9010, 30% gloss	2	-	-	-	Y
2a	Teetro to be 5mm Opal 030 with Avery 5500LD/82A BLUE translucent vinyl applied to face, flush in-laid and fixed to rear of panel with Big Head fixings and Simson ISR 70.03.	1	-	-	-	-
2b	TESCO to be 5mm Opal 030 with Avery 4509 RED 431 translucent vinyl applied to face, flush in-laid and fixed to rear of panel with Big Head fixings and Simson ISR 70.03.	1	-	-	-	-
2c	BLIPS to be 5mm Opal 030 with Avery 5500LD/82A BLUE translucent vinyl applied to face, flush in-laid and fixed to rear of panel with Big Head fixings and Simson ISR 70.03.	1	-	-	-	-
3	ASGLK081 extrusion frame, to be BROWN ARIZONA OAK finish	9	-	-	-	-
4	ASGLK016 extrusion brace, riveted to extrusion frame. To be left mill finish	27	-	-	-	-
5	3mm flat aluminium joining piece, 29x150mm. To be left mill finish	8	-	-	-	-
6	No.8x25mm Flange Head Self Tapper, touched up to match LWD	as req'd	-	-	-	-
7	3mm WHITE Foam PVC LED panel	2	-	-	-	-
8	Tetra MiniMAX 7100K LED's (GEMM7.2)	100	-	-	-	-
9	MEAN WELL LPV-60-12	1	-	-	-	-
10	Frame work from folded from 3mm aluminium z bracket welded to 45x8x3mm aluminium angle using 50x3mm strips (6mm fillet weld)	9	-	-	-	-
11	No.8x50mm Flange Head Self Tapper, touched up to match to match LWD	as req'd	-	-	-	-
12	Bonding to be 3M 5952 VHB tape. To be applied to full perimeter of frame and also vertical braces	as req'd	-	-	-	-
13	No.8x13mm Flange Head Self Tapper	as req'd	-	-	-	-
14	Fixings and anchors to suit substrate	as req'd	-	-	-	-

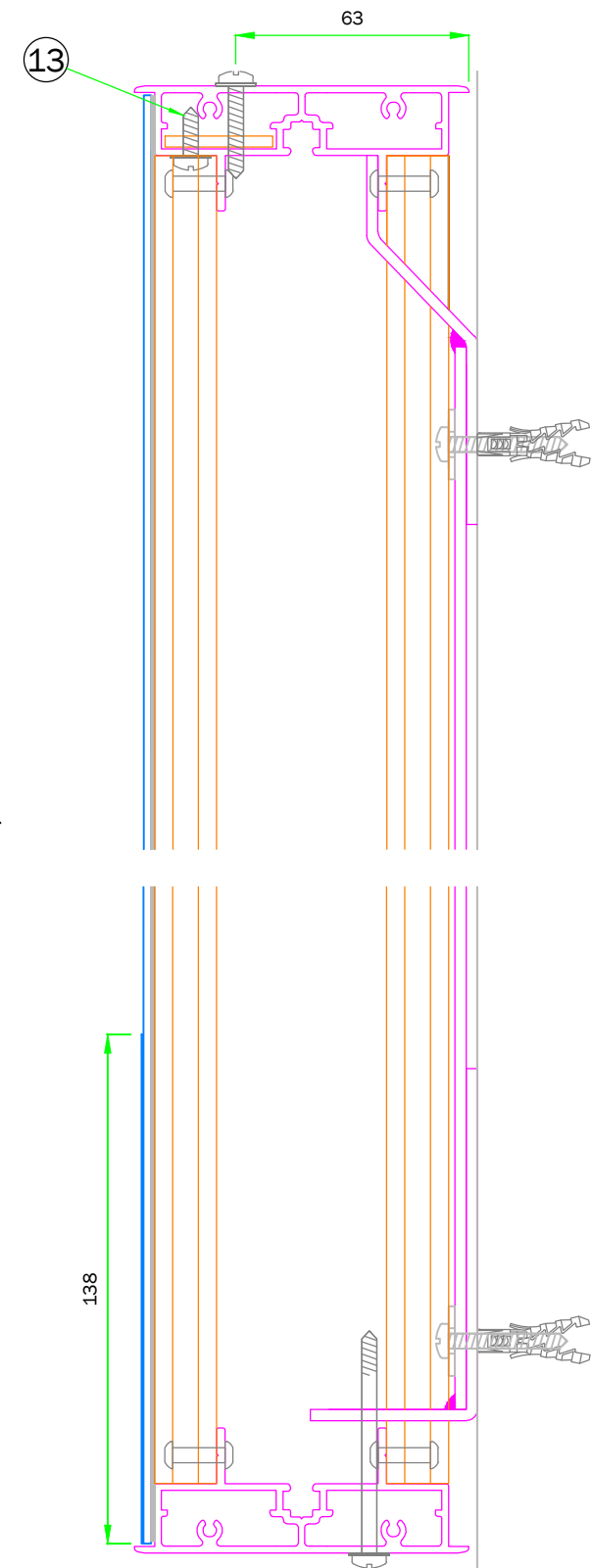

D Section D-D
scale 1:2

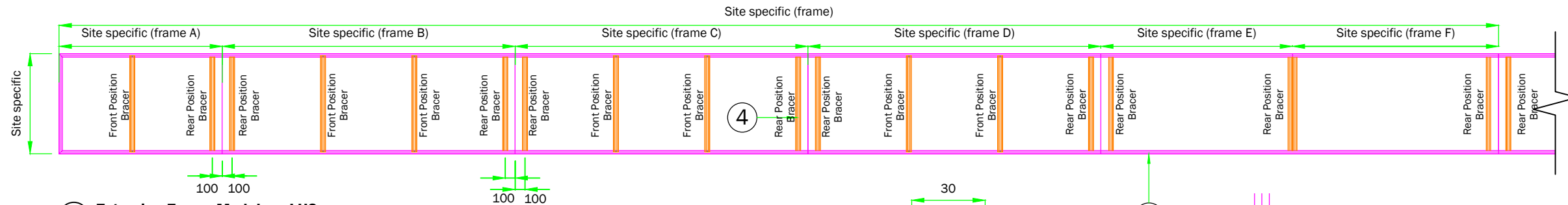

Extrusion Frame Modules - LHS
scale 1:50

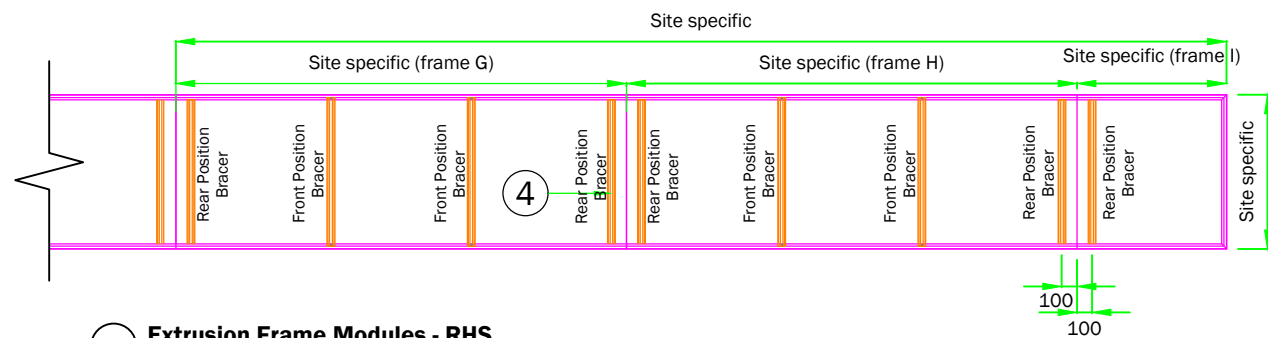

Extrusion Frame Modules - RHS
scale 1:50

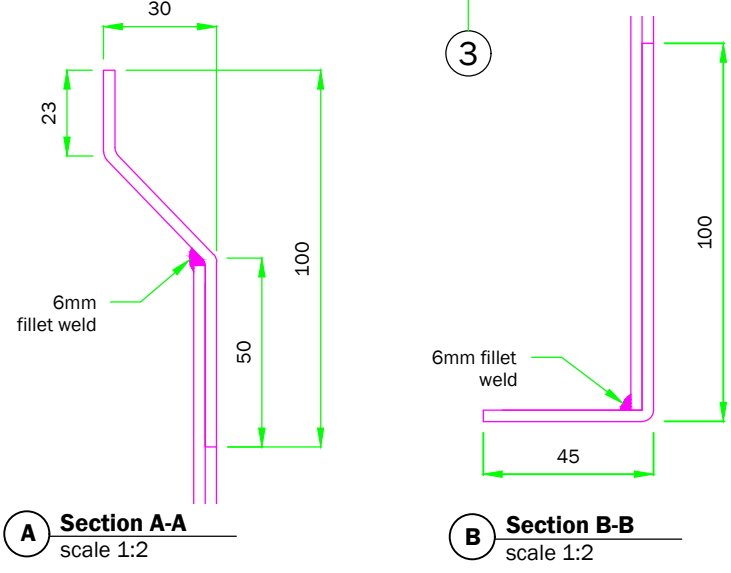

A Section A-A
scale 1:2

B Section B-B
scale 1:2

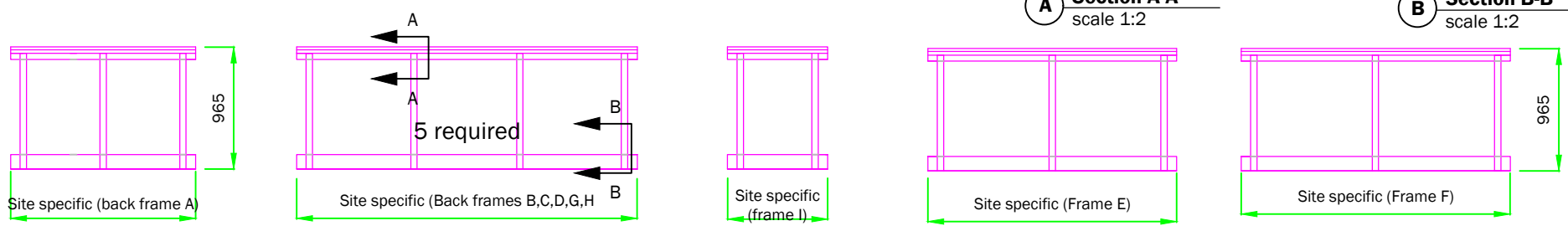

Back Frames
scale 1:50

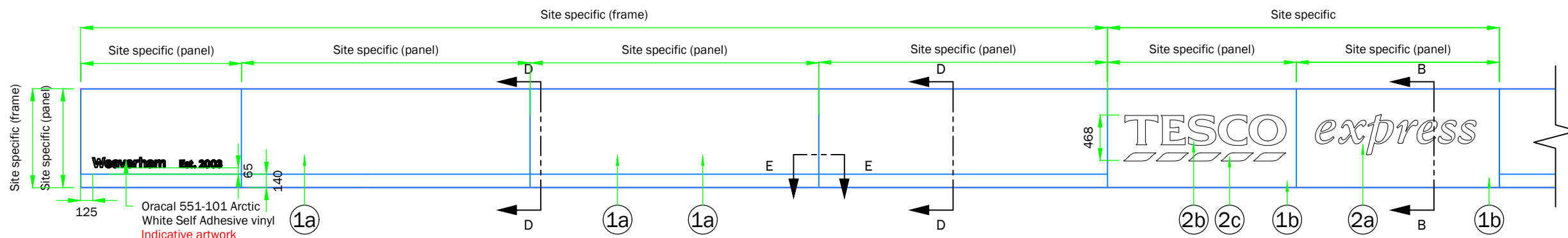

Fascia Elevation - LHS
scale 1:50

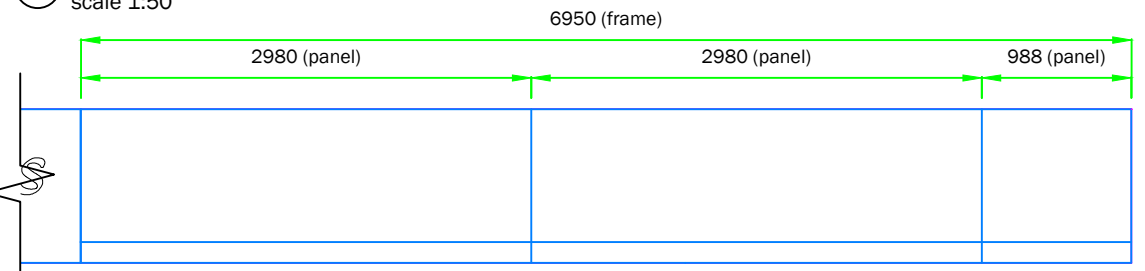

Fascia Elevation - RHS
scale 1:50

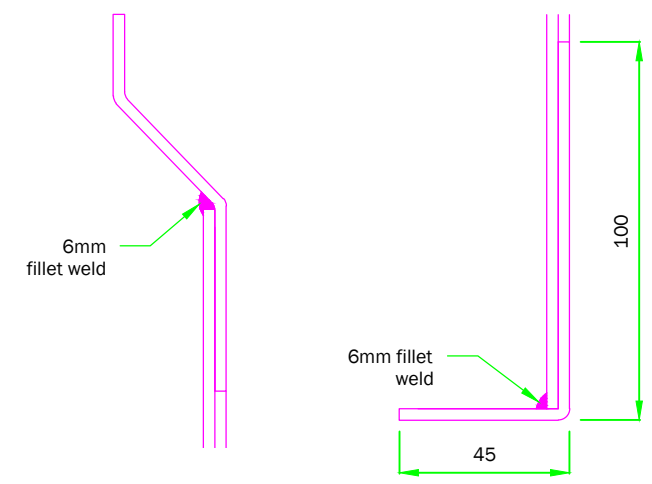

A Section A-A
scale 1:2

B Section B-B
scale 1:2

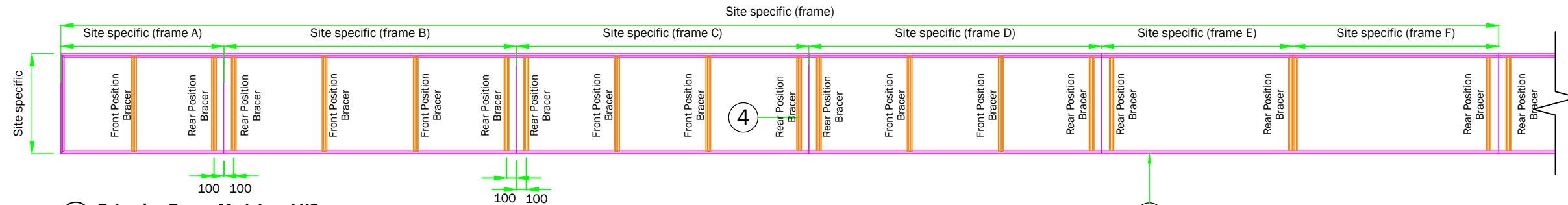

Extrusion Frame Modules - LHS
scale 1:50

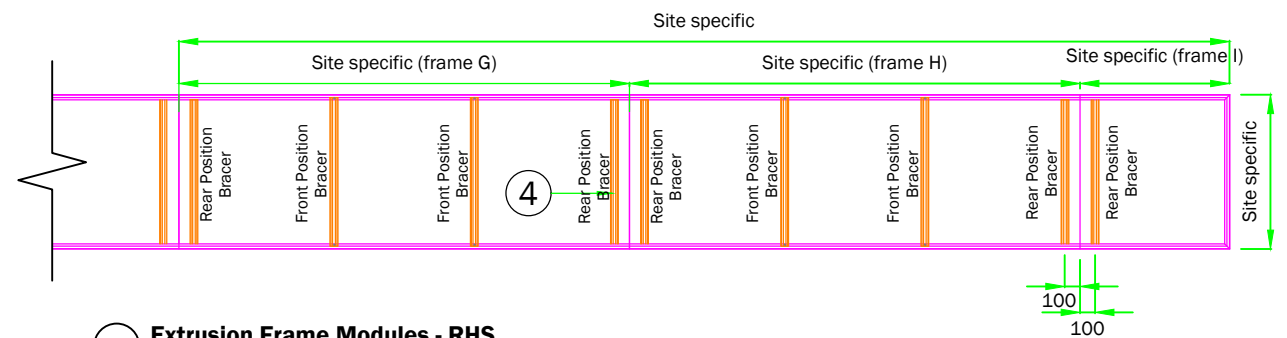

Extrusion Frame Modules - RHS
scale 1:50

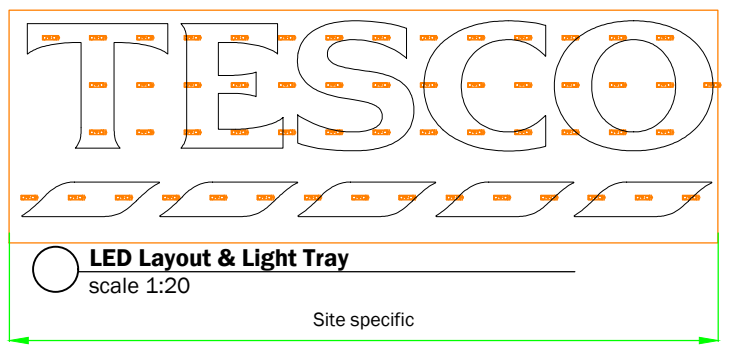

LED Layout & Light Tray
scale 1:20

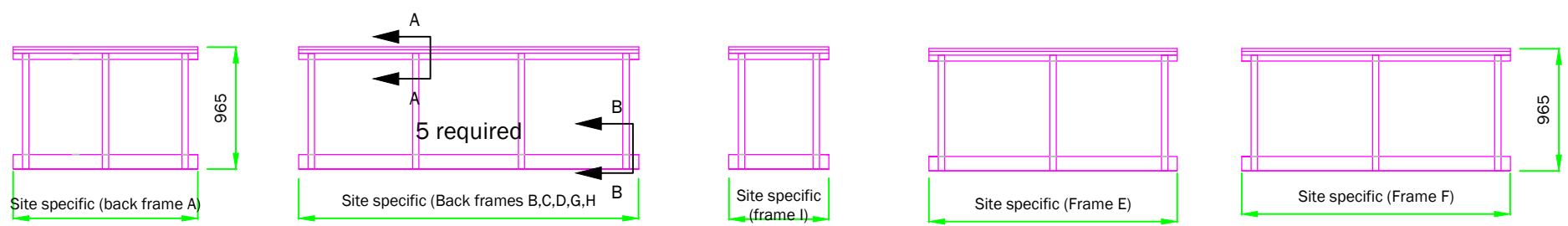
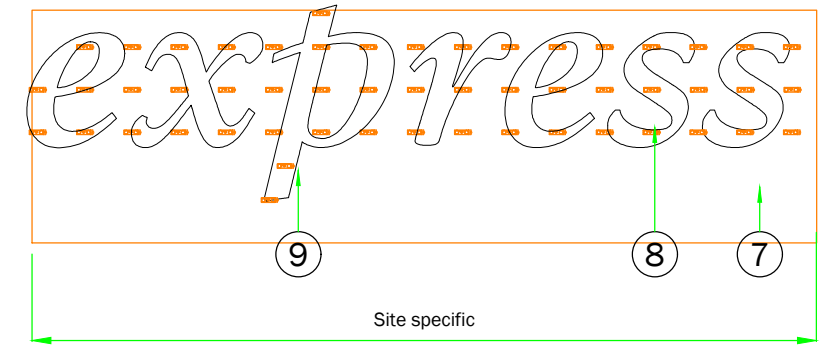

Back Frames
scale 1:50

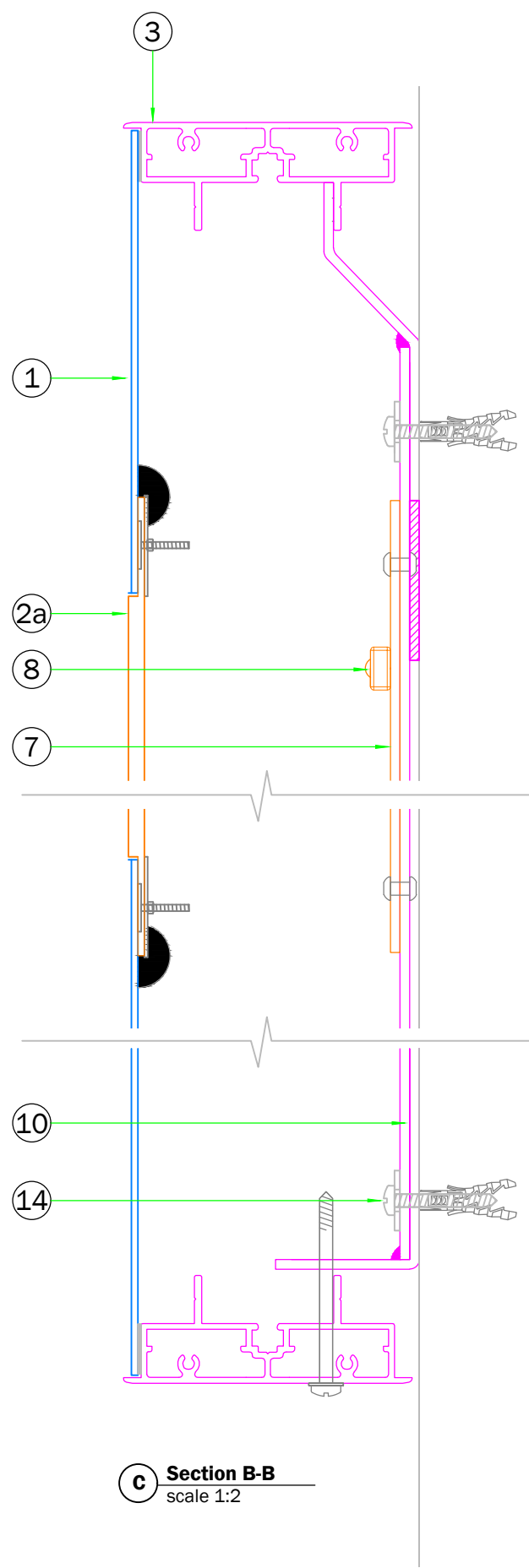

C Section B-B
scale 1:2

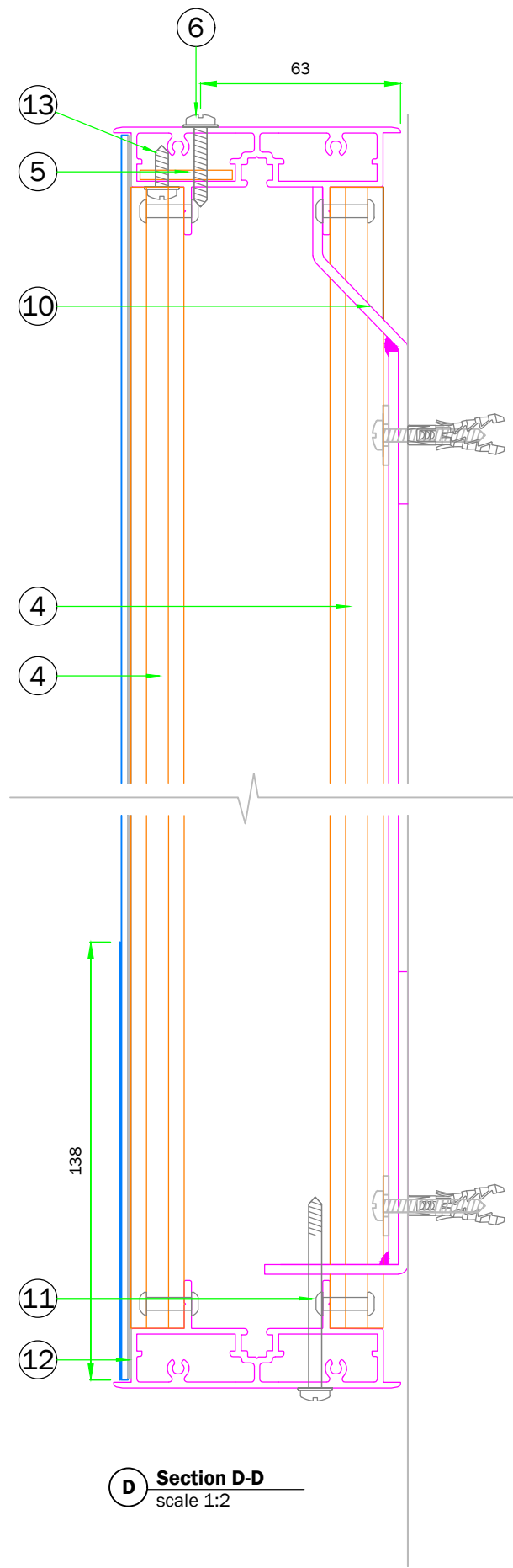

D Section D-D
scale 1:2

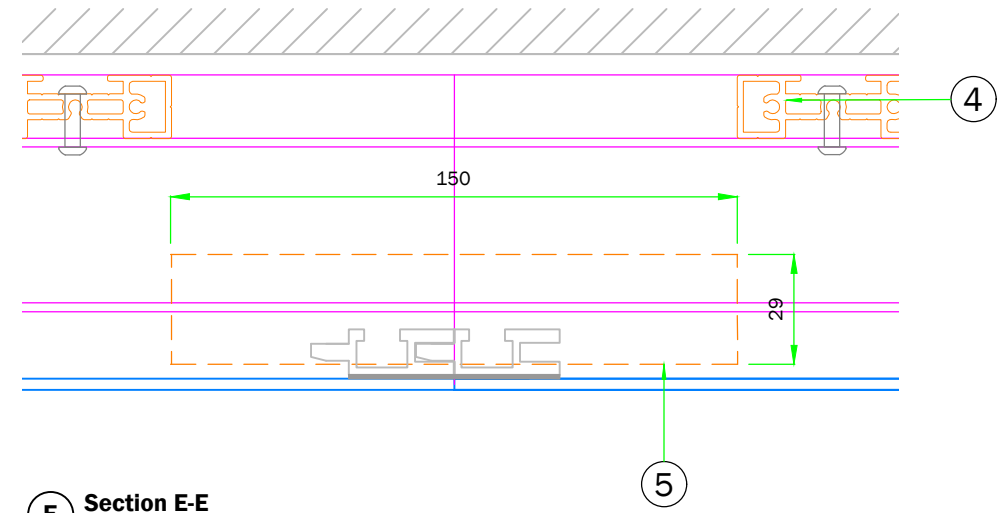

E Section E-E
scale 1:2

WRITTEN SPECIFICATION						
PART No.	DESCRIPTION	PART QTY.	PART WEIGHT (KG)	TOTAL WEIGHT (KG)	MATERIAL USAGE (UOM)	LEAD TIME RISK
1a	2mm aluminium panel, to be powdercoated BLUE RAL 5005, 30% gloss. BROWN ARIZONA OAK strip applied to face, to be digitally printed onto opaque WHITE vinyl - Metamark MD3-301M with Metaguard 300 MG-302 MATT overlaminate.	7	-	-	-	Y
1b	3mm fret cut aluminium panel, to be powdercoated WHITE RAL 9010, 30% gloss	2	-	-	-	Y
2a	'metro' to be 5mm Opal 030 with Avery 5600LD/82A BLUE translucent vinyl applied to face, flush in-laid and fixed to rear of panel with Big Head fixings and Simson ISR 70-03.	1	-	-	-	-
2b	'TESCO' to be 5mm Opal 030 with Avery 4509 RED 431 translucent vinyl applied to face, flush in-laid and fixed to rear of panel with Big Head fixings and Simson ISR 70-03.	1	-	-	-	-
2c	BLIPS to be 5mm Opal 030 with Avery 5600LD/82A BLUE translucent vinyl applied to face, flush in-laid and fixed to rear of panel with Big Head fixings and Simson ISR 70-03.	1	-	-	-	-
3	ASGUK081 extrusion frame, to be BROWN ARIZONA OAK finish	9	-	-	-	-
4	ASGUK016 extrusion bracer, riveted to extrusion frame. To be left mill finish	27	-	-	-	-
5	3mm flat aluminium joining piece, 29x150mm. To be left mill finish	8	-	-	-	-
6	No.8x25mm Flange Head Self Tapper, touched up to match LWO	as req'd	-	-	-	-
7	3mm WHITE Foam PVC LED panel	2	-	-	-	-
8	Tetra MiniMAX 7100K LEDs (GEMM71-2)	100	-	-	-	-
9	MEAN WELL LPV-60-12	1	-	-	-	-
10	Frame work from folded from 3mm aluminium z bracket welded to 45x45x3mm aluminium angle using 50x3mm straps (6mm fillet weld)	9	-	-	-	-
11	No.8x60mm Flange Head Self Tapper, touched up to match to match LWO	as req'd	-	-	-	-
12	Bonding to be 3M 5952 VHB tape. To be applied to full perimeter of frame and also vertical bracers	as req'd	-	-	-	-
13	No.8x13mm Flange Head Self Tapper	as req'd	-	-	-	-
14	Fixings and anchors to suit substrate	as req'd	-	-	-	-