

Application for consent to display an advertisement(s).

Town and Country Planning (Control of Advertisements) (England) Regulations 2007

**Publication of applications on planning authority websites.**

Please note that the information provided on this application form and in supporting documents may be published on the Authority's website. If you require any further clarification, please contact the Authority's planning department.

**1. Site Address**

Number	2
Suffix	
Property name	
Address line 1	Heathville Road
Address line 2	
Address line 3	
Town/city	Gloucester
Postcode	GL1 3DP

Description of site location must be completed if postcode is not known:

Easting (x)	383959
Northing (y)	218908

Description

--

**2. Applicant Details**

Title	Mr
First name	Rob
Surname	Tyler
Company name	Goodwin Funeral Directors
Address line 1	2, Heathville Road
Address line 2	
Address line 3	
Town/city	Gloucester

2. Applicant Details

Country

Postcode

GL1 3DP

Are you an agent acting on behalf of the applicant?

☒ Yes ☐ No

Primary number

Secondary number

Fax number

Email address

3. Agent Details

Title

Mr

First name

Adam

Surname

Greenslade

Company name

AG Project Services

Address line 1

33 Colin Road

Address line 2

Barnwood

Address line 3

Town/city

Gloucester

Country

United Kingdom

Postcode

GL4 3JL

Primary number

Secondary number

Fax number

Email

4. Type of Proposed Advertisement(s)

Please describe the proposed advertisement(s)

Proposed post sign located facing London Road and proposed door sign fixed above front door.

Please select the type(s) of advertising you are proposing:

☒ Fascia sign(s)

☐ Projecting or hanging sign(s)

☐ Hoarding(s)

☐ Other type(s)

Please add details of each proposed fascia sign

Fascia sign(s): 1

What is the height from the ground to the base of the advertisement?

2.2 metre(s)

4. Type of Proposed Advertisement(s)

What is the maximum projection of the advertisement from face of building?	0.1 metre(s)
Dimension:	Height: 0.49 x Width: 1.168 x Depth: 0.05 metre(s)
What materials will the sign be made of?  Steel / Aluminium	
What is the maximum height of any of the individual letters and symbols?	14 cm
The colour of text and background  The background is black and the text is gold	
Will the sign be illuminated?	No
Will the sign be illuminated internally or externally?	
Illuminance levels	0 cd/m2
Will the illumination be static or intermittent?	

Fascia sign(s): 2	
What is the height from the ground to the base of the advertisement?	1.1 metre(s)
What is the maximum projection of the advertisement from face of building?	0 metre(s)
Dimension:	Height: 1.104 x Width: 2.44 x Depth: 0.2 metre(s)
What materials will the sign be made of?  Steel	
What is the maximum height of any of the individual letters and symbols?	29 cm
The colour of text and background  The background is black and the text is gold	
Will the sign be illuminated?	No
Will the sign be illuminated internally or externally?	
Illuminance levels	0 cd/m2
Will the illumination be static or intermittent?	

5. Location of Advertisement(s)

Is the advertisement(s) you are applying for already in place?

☐ Yes ☒ No

Is an existing advertisement(s) to be removed and replaced by the advertisement(s) in this proposal?

☐ Yes ☒ No ☐ Not Applicable

Will the proposed advertisement(s) project over a footpath or other public highway?

☐ Yes ☒ No

6. Advertisement(s) Period

Please state the period of time for which consent is sought for the advertisement

From

01/11/2021

To

01/11/2026

## 7. Neighbour and Community Consultation

Have you consulted your neighbours or the local community about the proposal?

☐ Yes ☒ No

## 8. Site Visit

Can the site be seen from a public road, public footpath, bridleway or other public land?

☒ Yes ☐ No

If the planning authority needs to make an appointment to carry out a site visit, whom should they contact?

- ☐ The agent  
☒ The applicant  
☐ Other person

## 9. Pre-application Advice

Has assistance or prior advice been sought from the local authority about this application?

☐ Yes ☒ No

## 10. Interest In the Land

Does the applicant own the land or buildings where the adverts are to be placed?

☒ Yes ☐ No

## 11. Authority Employee/Member

With respect to the Authority, is the applicant and/or agent one of the following:

- (a) a member of staff  
(b) an elected member  
(c) related to a member of staff  
(d) related to an elected member

It is an important principle of decision-making that the process is open and transparent.

☐ Yes ☒ No

For the purposes of this question, "related to" means related, by birth or otherwise, closely enough that a fair-minded and informed observer, having considered the facts, would conclude that there was bias on the part of the decision-maker in the Local Planning Authority.

Do any of the above statements apply?

## 12. Declaration

I/we hereby apply for planning permission/consent as described in this form and the accompanying plans/drawings and additional information. I/we confirm that, to the best of my/our knowledge, any facts stated are true and accurate and any opinions given are the genuine opinions of the person(s) giving them. ☒

Date (cannot be pre-application)



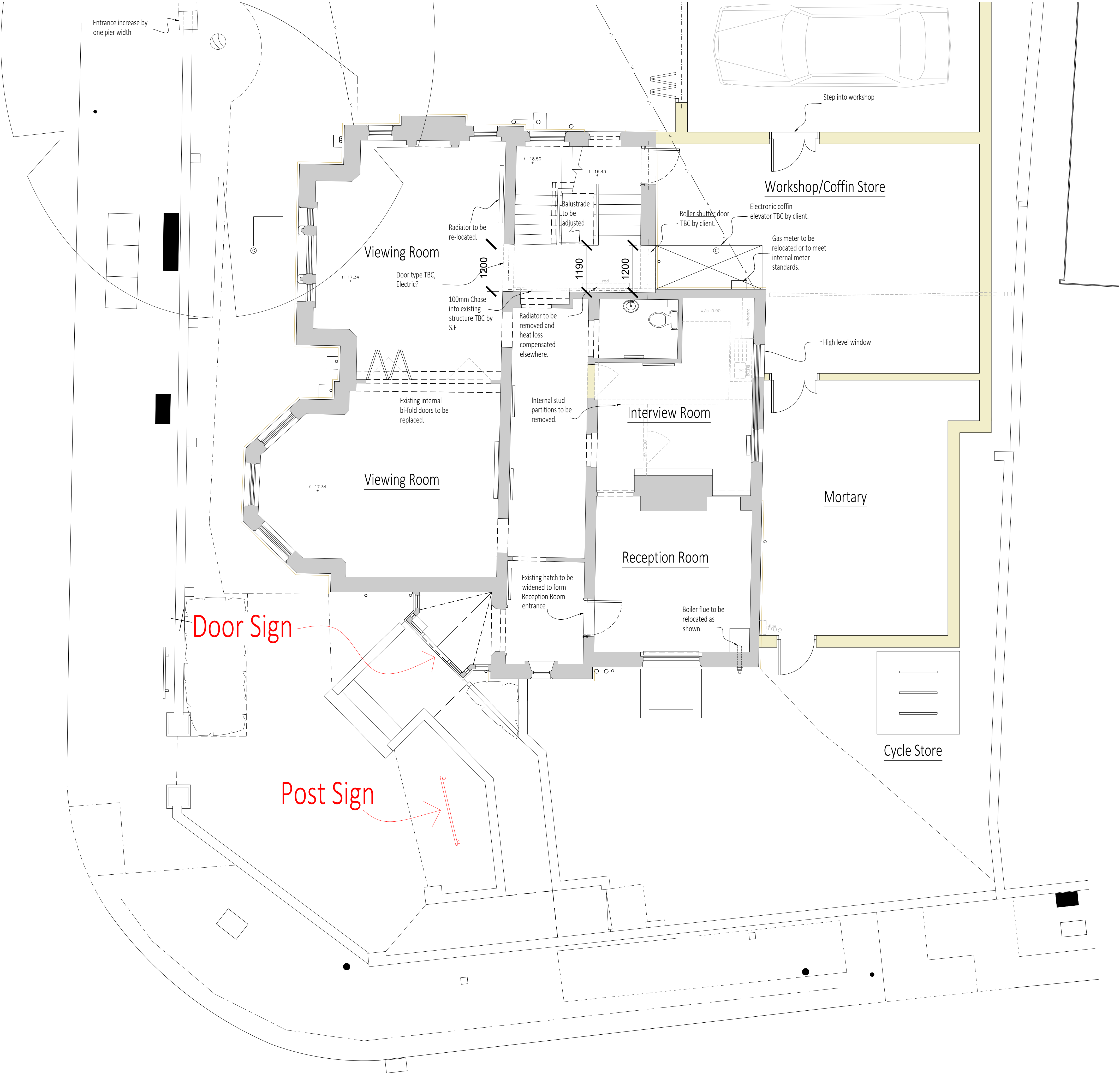

Notes:

- These drawings are subject to Planning or any other statute in law before work commencing.
- All drawings marked 'Draft', 'Preliminary', 'Tender' or 'Planning' are not to be built or manufactured from.
- Only the local Authority Planning departments may scale from these drawings.
- The client is to ensure all Party Wall Agreements are in place before work commences.

revision	date	description
P1	02.02.22	Post sign width updated to suit revised proof.



client		
Mr Robert Tyler (Goodwin Funeral Directors)		
location		
Peter Scott House, Gloucester.		
drawing number	revision	
293-300	P1	
drawing status		
PLANNING		
drawing title		
Proposed Signage Plan		
project description		
Peter Scott House - Change of use		
project	scale	date
Ref: 293	1/50@ A1	August 2019

This drawing is copyright of AG Project Services. Do not reproduce this in whole or part without written permission. Only use figured dimensions, do not scale.



# Goodwins

## Funeral Directors

Independent Family Business Established 1883











**Goodwins**  
**Funeral Directors**  
**Tel: 01452 309903**

Independent Family Business Established 1883



# Goodwins Funeral Directors

Tel: 01452 309903

Independent Family Business Established 1883

900 mm

1800 mm

209 mm

116 mm

111 mm

39.4 mm