

University of Gloucestershire
**University of Gloucestershire, City
Campus**

External Lighting Statement

GCC-ARUP-ZZ-XX-RP-E-0001

Issue | 9 December 2021

This report takes into account the particular instructions and requirements of our client. It is not intended for and should not be relied upon by any third party and no responsibility is undertaken to any third party.

Job number 282739-00

Ove Arup & Partners Ltd
63 St Thomas Street
Bristol BS1 6JZ
United Kingdom
www.arup.com

ARUP

Introduction

Introduction

This statement outlines the RIBA Stage 2 proposals for the external lighting of University of Gloucestershire City Campus.

The UoG City Campus is a redevelopment of the former Gloucester Debenhams store into a new campus for the University.

The statement has been prepared to support the planning application for the works. The proposals outlined will be developed over subsequent design stages with detailed layouts and lighting calculations being undertaken during RIBA Stage 4 – Technical Design.

Design Criteria

The main purpose of external lighting within the development will be to provide pedestrians, cyclists and vehicles a safe route into the courtyard. There is also the desire to highlight the building's entrance, signage and some key architectural features.

Codes and Guidance

The lighting design will comply with the relevant codes and guidance including:

- BS EN 12464-2:2014: Lighting of work places - Outdoor work places
- BS 5489-1:2020: Design of road lighting - Lighting of roads and public amenity areas. Code of practice
- SLL Lighting Guide 6: Lighting of the Outdoor Environment
- ILP GN01-21 The Reduction of Obtrusive Light
- ILP GN08-18 Bats and Artificial Lighting in the UK
- BS5266-1:2016: Emergency Lighting - Code of practice for the emergency escape lighting of premises
- BS 8300:2018 Design of an accessible and inclusive built environment
- Historic England Lighting of Heritage Buildings

Concepts

External Lighting Concept

The lighting design concept has split the development into two key parts:

1. Courtyard Area
2. Building Facades

Each of these areas has different needs and requirements from the external lighting scheme. Figure 1 shows the breakdown of these areas.

Courtyard Area

The courtyard area has been split into three sub areas which have had the following colours applied on figure 1.

The purpose of this lighting is to enable people to safely navigate the space, provide security and enable CCTV coverage.

Pedestrian/Cycle Access and Cycle Storage

This area will predominantly be lit using wall mounted asymmetric lighting which will control and focus the lighting to only the areas it is required.

Some architectural façade and illuminated signage may be provided.



Parking Spaces

This area will predominantly be lit through columns mounted at the rear of the parking spaces with asymmetric light distribution to focus the light onto the parking bays and minimise spill light out of the courtyard.

Vehicle Access and Movement

This area will be lit through a combination of columns and building mounted lighting with light controlled to minimise spill outside of the courtyard area.

Building Facades

-  Kings Square and
-  The Oxebode/Northgate St

The concept for lighting the building facades is further expanded over the following pages.

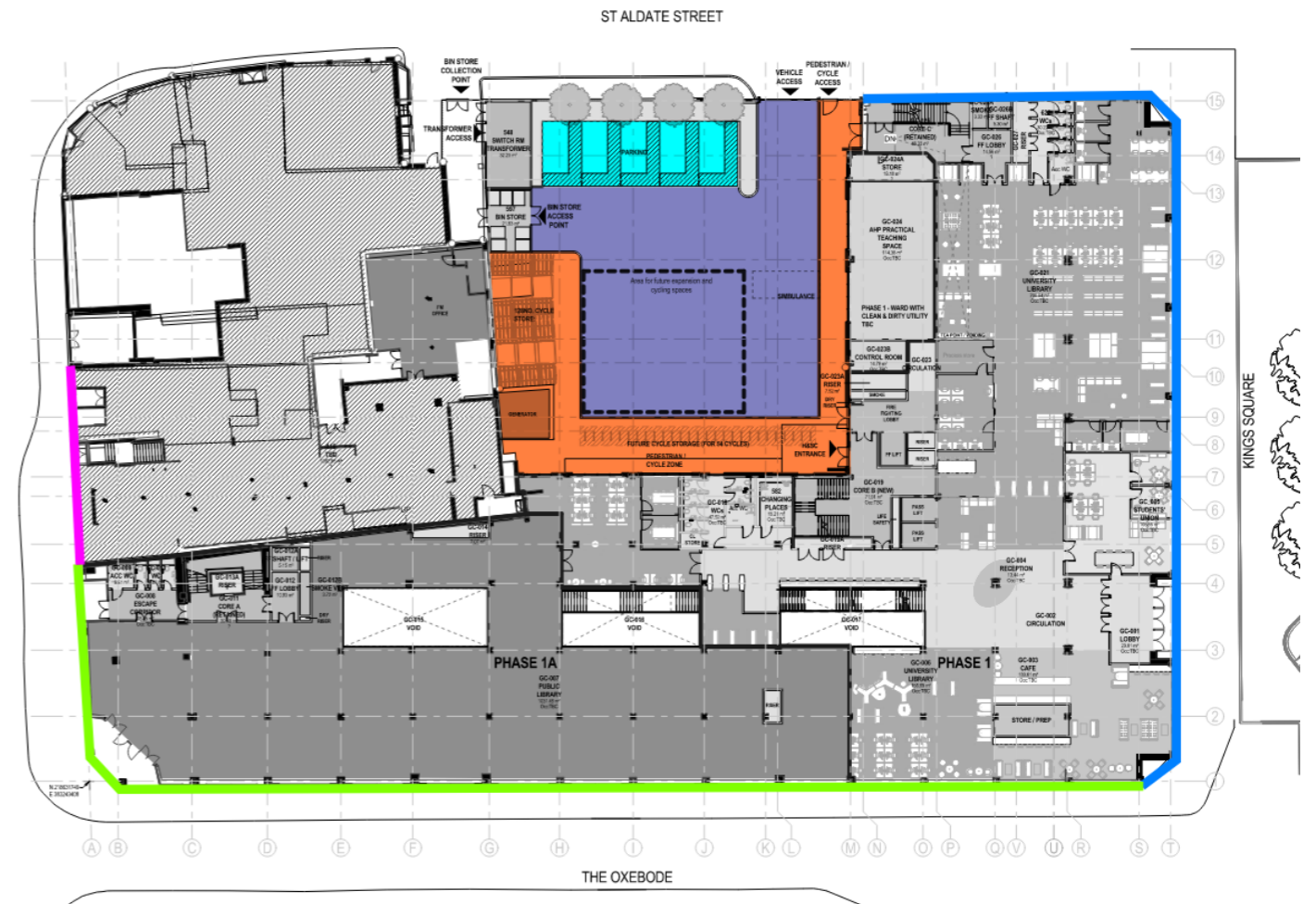

Figure 1 – External Lighting Concept Overview

Lighting Concepts – Kings Square and The Oxebode/Northgate Street

Kings Square

Façade

The façade will be provided with lighting to highlight the architectural features as shown in figure 2. This will predominately be the stone pillars running the height of the façade.

Entrance

The existing entrance on Kings Square is being utilised as a key student and visitor entrance to the campus. This is a recessed entrance and will be illuminated using recessed downlights. This will give a clear and welcoming entrance from Kings Square.

Signage

High levels signage will be provided to the façade that will be illuminated.

Street Lighting

There is existing street lighting mounted on the façade of the building along Kings Square and a planning application has been submitted by other (ref 18/01454/FUL) to replace this as part of the Kings Square redevelopments works. Further development will be taken to incorporate a new proposal to replace the existing street lighting in a way that is complimentary to the architectural intent of the scheme.

The Oxebode and Northgate Street

Façade

The intent is to illuminate the façade along The Oxebode that wraps around onto Northgate Street. This will be done in a historically sensitive way that enhances the building while minimising energy use and light spill.

As there is existing column lighting along the pavement adjacent to the building the current intent will be to provide this light from the first floor up however this intent will be developed to be complimentary to the existing street furniture.

Entrance

The entrance that is situated on the corner of The Oxebode an Northgate Street is recessed in and therefore will be illuminated using recess downlighters.



Figure 2 - Kings Square Façade Concept



Figure 3 - The Oxebode Façade Concept

Façade Lighting Images



Sheffield City Hall



Royal Liver Building